

- STUDIO UNIT**
- 1 BED ROOM**
- 3 BED ROOM**
- FIRE EXIT**
- ELEVATOR**

Republic of the Philippines
Department of Public Works
Transportation and Communication
LAPU-LAPU CITY

RECOMMENDING ISSUANCE:

HEAD BLDG. ARCHITECTURAL: _____ DATE: _____

ISSUED BY: _____

BUILDING OFFICIAL: _____ DATE: _____

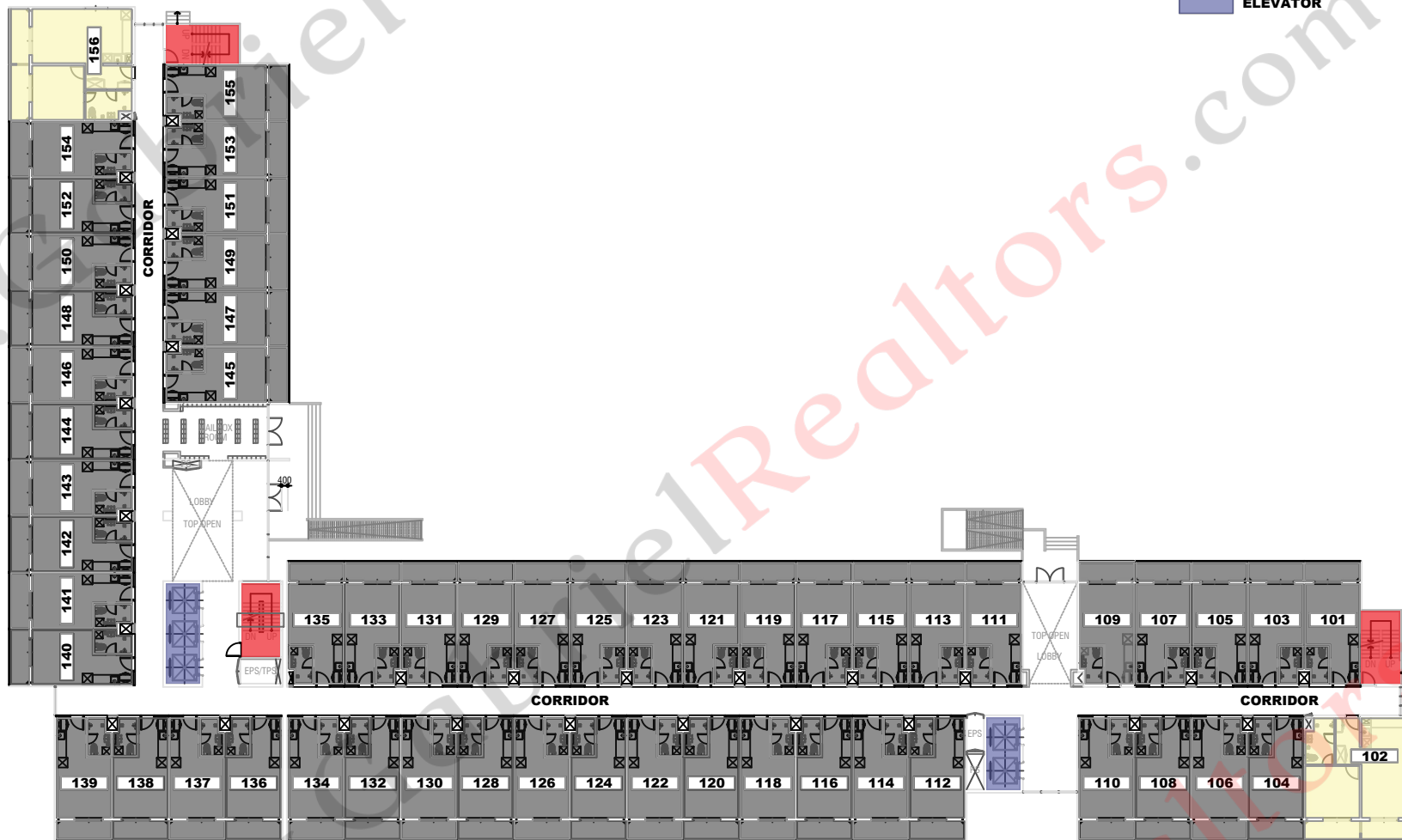

A
12/01

1F PLAN (BLDG 102)
SCALE: 1/300

 D. DAN CEBU ARCHITECTS <small>40 MEZZANINE FLOOR, 455 BGC, SKYWAY ONE CORNER C.S. ROAD, ST. CEBU CITY 6000 CONTACT NO. 031-8800 0000/031-8800 0000/031-8800 0000 WWW.CEBUARCHITECTS.COM</small>	ARCHITECT	PROJECT TITLE	OWNER	SHEET CONTENTS	SHEET CONTENTS	DESIGN: DDN	DATE: 2021-01	SHEET NO.
	DENNIS DAN T. NUÑEZ, UAP CEBU CITY	SAEKYUNG OCEAN RESIDENCES	SKB MABUHAY REALTY CO. RAYMUND FRANCISCO SAEKYUNG 956, CALTEX RD, LAPU-LAPU CITY, CEBU, PHILIPPINES	AS SHOWN	DDN DDN AS SHOWN	CHECKED DDN AS SHOWN	PROJECT LICENSE NO.: 3ARLPS-AGAL2N-0811A-A-XBKAND	DATE: 2021-01
PRC NO. : 0019753 REG. DATE: FEB. 23, 2005	PTR NO. : 696070 ISSUED ON: CEBU CITY	DATE: JAN. 06, 2021 TIN: 239-853-409-000	LOCATION: SUBA-BASBAS RD, SUBA-BASBAS, LAPU-LAPU CITY, CEBU, PHILIPPINES			<small>This drawing is copyright. Contractors must check all dimensions on site, any figure dimensions are to be worked on. Discrepancies must be reported to the Architect before commencing.</small>		

- STUDIO UNIT**
- 1 BED ROOM**
- 3 BED ROOM**
- FIRE EXIT**
- ELEVATOR**

Republic of the Philippines Department of Public Works Transportation and Communication LAPU-LAPU CITY	
RECOMMENDING ISSUANCE:	
HEAD BLDG. ARCHITECTURAL:	DATE:
ISSUED BY:	
BUILDING OFFICIAL:	DATE:

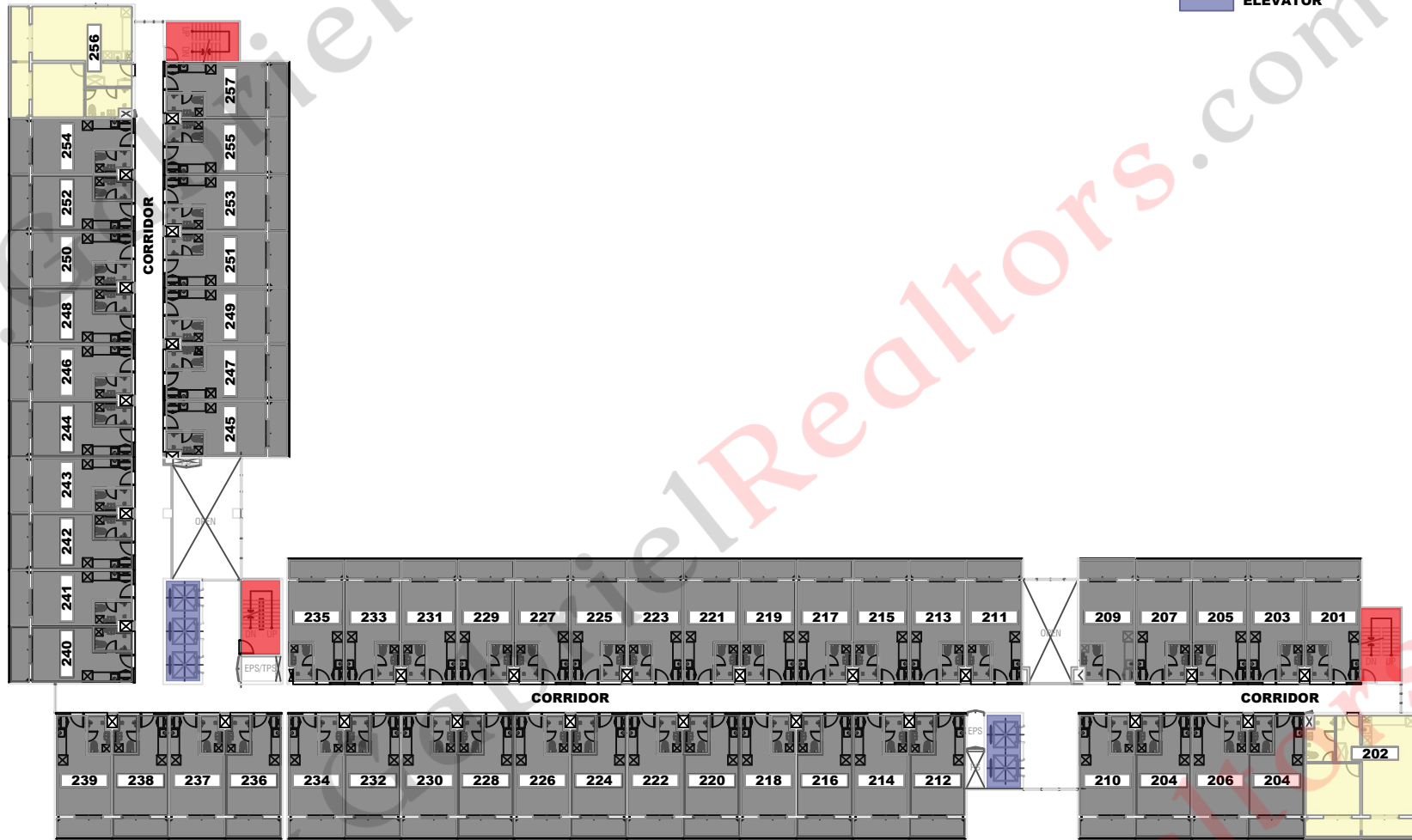

A
1301

2F PLAN (BLDG 102)
SCALE: 1/300

<p>D. DAN CEBU ARCHITECTS 501 MEZZANINE FLOOR, 4515 BGC, SKYWAY ANEX, CORNER C.E. ROSA ST., CEBU CITY 6000 CONTACT NO. 031-8800100; 0905-285-2851; 0917-486-8188 WWW.CEBUARCHITECTS.COM</p>	ARCHITECT	PROJECT TITLE	OWNER	SHEET CONTENTS	SHEET CONTENTS	DESIGN	DDN	DATE:	2021-01	SHEET NO.
	DENNIS DAN T. NUÑEZ, JAP CEBU CITY	SAEKYUNG OCEAN RESIDENCES	SKB MABUHAY REALTY CO. RAYMUND FRANCISCO	SAEKYUNG 956 CALTEX RD. LAPU-LAPU CITY, CEBU, PHILIPPINES	AS SHOWN	AS SHOWN	LOAD BY	DDN	CHECKED	
PRC NO. : 0019753	PTR NO. : 696070	DATE: JAN. 06, 2021	LOCATION: SUBA-BASBAS RD, SUBA-BASBAS, LAPU-LAPU CITY, CEBU, PHILIPPINES			This drawing is an instrument of service as a member of the Architect and/or civil engineer is considered or signed in part or in whole without their consent. All drawings are to be made under the supervision of the architect.				
REG. DATE: FEB. 23, 2005	ISSUED ON: CEBU CITY	TIN: 239-853-409-000				PROJECT/PROFESSIONAL LICENSE NO. : 34RLPS-AGAL20-0811A-XBKAND				

- STUDIO UNIT**
- 1 BED ROOM**
- 3 BED ROOM**
- FIRE EXIT**
- ELEVATOR**

Republic of the Philippines
Department of Public Works
Transportation and Communication
LAPU-LAPU CITY

RECOMMENDING ISSUANCE:

HEAD BLDG. ARCHITECTURAL: _____ DATE: _____

ISSUED BY: _____

BUILDING OFFICIAL: _____ DATE: _____

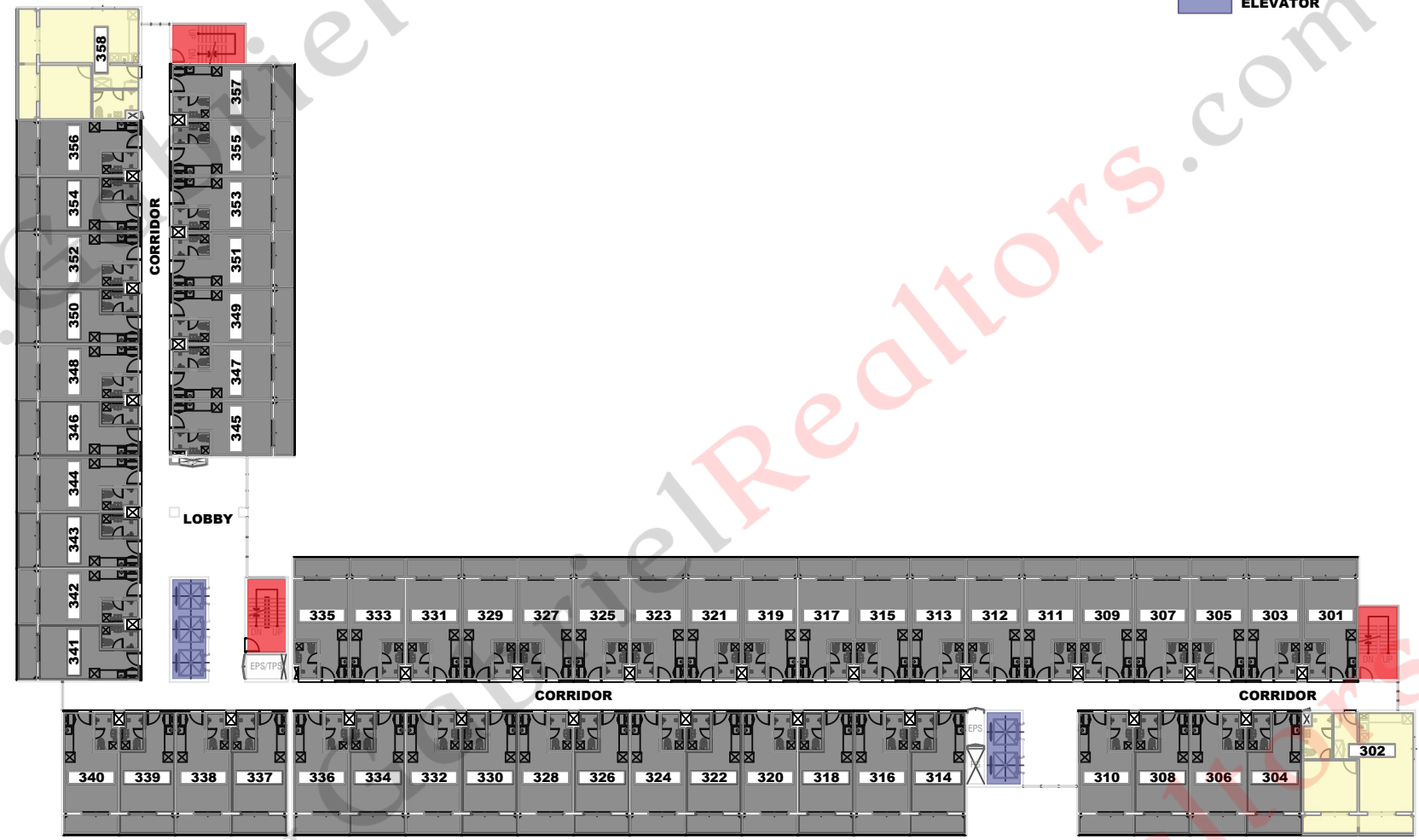

A
1401

3F PLAN (BLDG 102)
SCALE: 1/300

<p>D. DAN CEBU ARCHITECTS 5th MEZZANINE FLOOR, 655 B. ROAD, SUPERBLOCK ONE, CORNELIUS P. ROSA, ST., CEBU CITY 6000 CONTACT NO. 031-5000-0000 (09:00 AM - 05:00 PM) WWW.CEBUARCHITECTS.COM</p>	ARCHITECT DENNIS DAN T. NUÑEZ, UAP CEBU CITY	PROJECT TITLE SAEKYUNG OCEAN RESIDENCES	OWNER SKB MABUHAY REALTY CO. RAYMUND FRANCISCO SAEKYUNG 956, CALTEX RD. LAPU-LAPU CITY, CEBU, PHILIPPINES	SHEET CONTENTS AS SHOWN	DESIGN: DDN DATE: 2021-01 CHECKED: _____ SCALE: AS SHOWN PROJECT CAD LICENSE NO.: 3ARLPS-AGAZ2N-0B11AA-XBKAND	SHEET NO. A 1401
	PRC NO. : 0019753 REG. DATE: FEB. 23, 2005	PTR NO. : 696070 ISSUED ON: CEBU CITY	DATE: JAN. 06, 2021 LOCATION: SUBA-BASBAS RD, SUBA-BASBAS, LAPU-LAPU CITY, CEBU, PHILIPPINES	TIN: 239-853-409-000	AS SHOWN	SHEET NO. A 1401

- STUDIO UNIT**
- 1 BED ROOM**
- 3 BED ROOM**
- FIRE EXIT**
- ELEVATOR**

Republic of the Philippines
Department of Public Works
Transportation and Communication
LAPU-LAPU CITY

RECOMMENDING ISSUANCE:

HEAD BLDG. ARCHITECTURAL: _____ DATE: _____

ISSUED BY: _____

BUILDING OFFICIAL: _____ DATE: _____

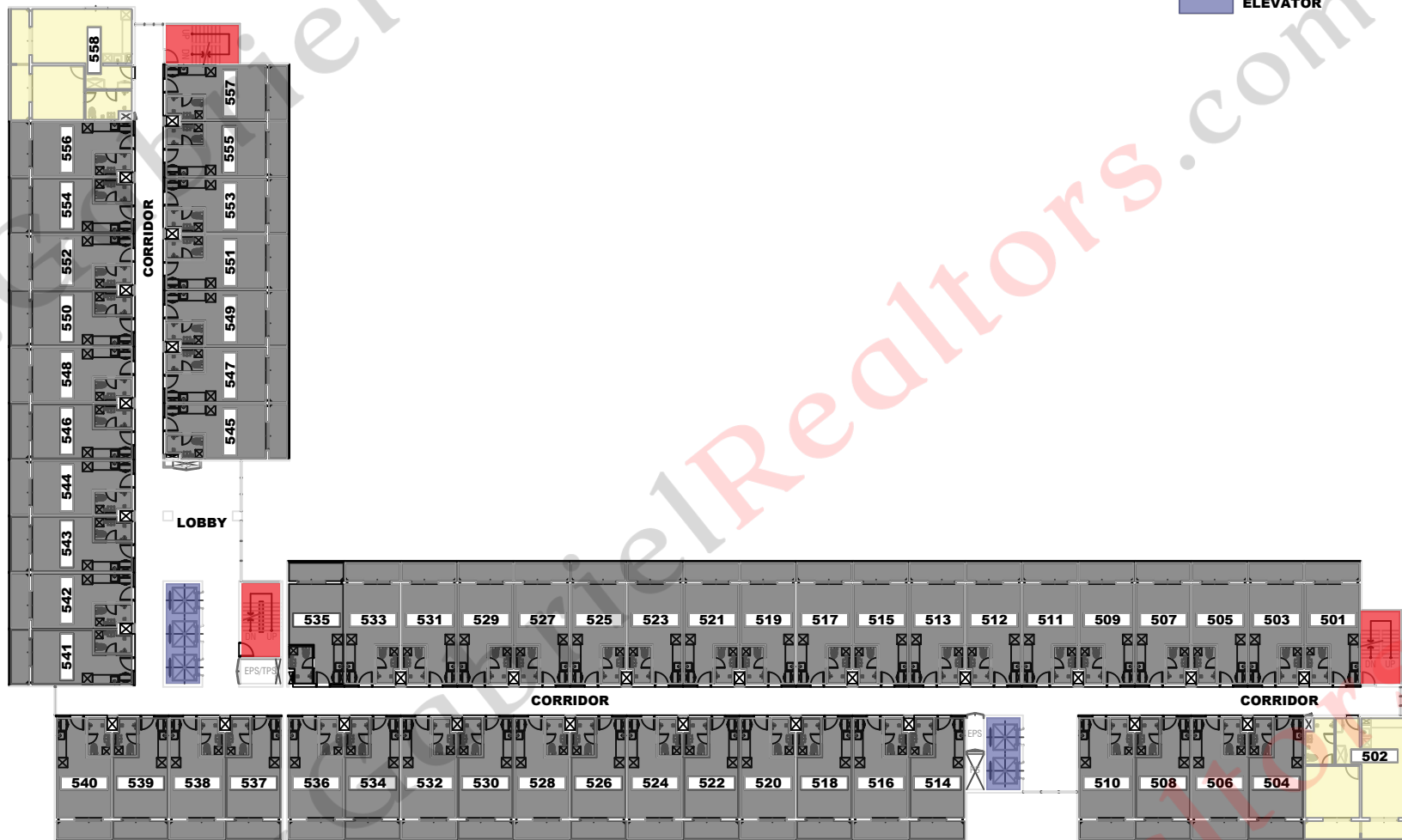

A
1401

5F PLAN (BLDG 102)
SCALE: 1/300

	ARCHITECT	PROJECT TITLE	OWNER	SHEET CONTENTS	SHEET CONTENTS	DESIGN: DDN	DATE: 2021-01	SHEET NO.
	DENNIS DAN T. NUÑEZ, JAP CEBU CITY	SAEKYUNG OCEAN RESIDENCES	SKB MABUHAY REALTY CO. RAYMUND FRANCISCO	SAEKYUNG 956 CALTEX RD. LAPU-LAPU CITY, CEBU, PHILIPPINES	AS SHOWN	AS SHOWN	LADD BY: DDN SCALE: AS SHOWN	CHECKED: _____ PROJECT/CD LICENSE NO.: 3ARLPS-AGAZ2N-0B11A-A-XBKAND
D. DAN CEBU ARCHITECTS 5th MEZZANINE FLOOR, 615 B.C. ROAD, SUPERBLOCK ONE, CORNER C.E. ROSA, ST., CEBU CITY 6000 CONTACT NO. 031-520001000-031-520010000 WWW.CEBUARCHITECTS.COM	PRC NO. : 0019753 PTR NO. : 696070 DATE: JAN. 06, 2021 REG. DATE: FEB. 23, 2005 ISSUED ON: CEBU CITY TIN: 239-853-409-000	LOCATION: SUBA-BASBAS RD, SUBA-BASBAS, LAPU-LAPU CITY, CEBU, PHILIPPINES	THIS DRAWING IS AN INSTRUMENT OF SERVICE AS A MEMBER OF THE ARCHITECTS AND AN INSTRUMENT OF PROFESSIONAL RESPONSIBILITY AND SHALL BE USED ONLY FOR THE PROJECT AND SITE SPECIFICALLY IDENTIFIED HEREIN. NO PART OF THIS DRAWING SHALL BE REPRODUCED OR TRANSMITTED IN ANY FORM OR BY ANY MEANS, ELECTRONIC OR MECHANICAL, WITHOUT THE WRITTEN PERMISSION OF THE ARCHITECT.	THIS DRAWING IS AN INSTRUMENT OF SERVICE AS A MEMBER OF THE ARCHITECTS AND AN INSTRUMENT OF PROFESSIONAL RESPONSIBILITY AND SHALL BE USED ONLY FOR THE PROJECT AND SITE SPECIFICALLY IDENTIFIED HEREIN. NO PART OF THIS DRAWING SHALL BE REPRODUCED OR TRANSMITTED IN ANY FORM OR BY ANY MEANS, ELECTRONIC OR MECHANICAL, WITHOUT THE WRITTEN PERMISSION OF THE ARCHITECT.	THIS DRAWING IS AN INSTRUMENT OF SERVICE AS A MEMBER OF THE ARCHITECTS AND AN INSTRUMENT OF PROFESSIONAL RESPONSIBILITY AND SHALL BE USED ONLY FOR THE PROJECT AND SITE SPECIFICALLY IDENTIFIED HEREIN. NO PART OF THIS DRAWING SHALL BE REPRODUCED OR TRANSMITTED IN ANY FORM OR BY ANY MEANS, ELECTRONIC OR MECHANICAL, WITHOUT THE WRITTEN PERMISSION OF THE ARCHITECT.	THIS DRAWING IS AN INSTRUMENT OF SERVICE AS A MEMBER OF THE ARCHITECTS AND AN INSTRUMENT OF PROFESSIONAL RESPONSIBILITY AND SHALL BE USED ONLY FOR THE PROJECT AND SITE SPECIFICALLY IDENTIFIED HEREIN. NO PART OF THIS DRAWING SHALL BE REPRODUCED OR TRANSMITTED IN ANY FORM OR BY ANY MEANS, ELECTRONIC OR MECHANICAL, WITHOUT THE WRITTEN PERMISSION OF THE ARCHITECT.	THIS DRAWING IS AN INSTRUMENT OF SERVICE AS A MEMBER OF THE ARCHITECTS AND AN INSTRUMENT OF PROFESSIONAL RESPONSIBILITY AND SHALL BE USED ONLY FOR THE PROJECT AND SITE SPECIFICALLY IDENTIFIED HEREIN. NO PART OF THIS DRAWING SHALL BE REPRODUCED OR TRANSMITTED IN ANY FORM OR BY ANY MEANS, ELECTRONIC OR MECHANICAL, WITHOUT THE WRITTEN PERMISSION OF THE ARCHITECT.	THIS DRAWING IS AN INSTRUMENT OF SERVICE AS A MEMBER OF THE ARCHITECTS AND AN INSTRUMENT OF PROFESSIONAL RESPONSIBILITY AND SHALL BE USED ONLY FOR THE PROJECT AND SITE SPECIFICALLY IDENTIFIED HEREIN. NO PART OF THIS DRAWING SHALL BE REPRODUCED OR TRANSMITTED IN ANY FORM OR BY ANY MEANS, ELECTRONIC OR MECHANICAL, WITHOUT THE WRITTEN PERMISSION OF THE ARCHITECT.

- STUDIO UNIT**
- 1 BED ROOM**
- 3 BED ROOM**
- FIRE EXIT**
- ELEVATOR**

Republic of the Philippines
Department of Public Works
Transportation and Communication
LAPU-LAPU CITY

RECOMMENDING ISSUANCE:

HEAD BLDG. ARCHITECTURAL: _____ DATE: _____

ISSUED BY: _____

BUILDING OFFICIAL: _____ DATE: _____

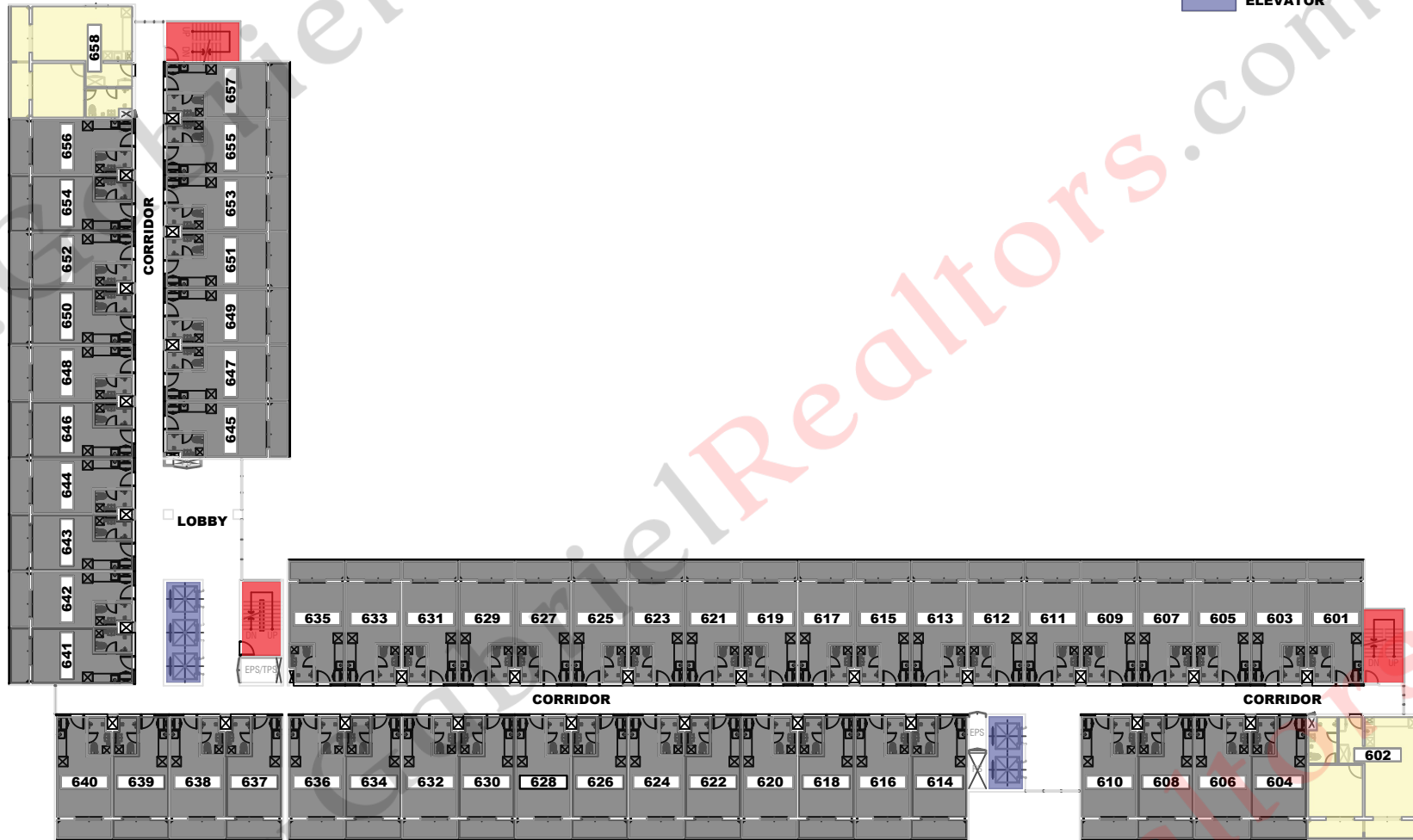

A
1401

6F PLAN (BLDG 102)
SCALE: 1/300

<p>ARCHITECT</p> <p style="text-align: center;"><u>DENNIS DAN T. NUÑEZ, UAP</u></p> <p style="text-align: center;">CEBU CITY</p>	<p>PROJECT TITLE</p> <p style="text-align: center;">SAEKYUNG OCEAN RESIDENCES</p>	<p>OWNER</p> <p>SKB MABUHAY REALTY CO. RAYMUND FRANCISCO</p> <p>SAEKYUNG 956 CALTEX RD. LAPU-LAPU CITY, CEBU, PHILIPPINES</p>	<p>SHEET CONTENTS</p> <p>AS SHOWN</p>	<p>DESIGN</p> <p>DDN</p> <p>DATE: 2021-01</p>	<p>SHEET NO.</p> <p style="text-align: center;">A 1401</p>
<p>D. DAN CEBU ARCHITECTS 502 MEZZANINE FLOOR, 615 BLDG. SEASIDEVIEW AVE. CORNER U.S. POSTAL ST., CEBU CITY 6000 CONTACT NO. 05330001000/0533333333/0533333333 WWW.CEBUARCHITECTS.COM</p>	<p>PRC NO. : 0019753 PTR NO. : 696070 DATE: JAN. 06, 2021</p> <p>REG. DATE: FEB. 23, 2005 ISSUED ON: CEBU CITY TIN: 239-853-409-000</p>	<p>LOCATION: SUBA-BASBAS RD, SUBA-BASBAS, LAPU-LAPU CITY, CEBU, PHILIPPINES</p>	<p>PROJECT/CAD LICENSE NO. : 3ARLPS-AGAZ02H-0811AA-XBKAND</p>	<p>This drawing is an instrument of service in a contract with the Architect and is not to be reproduced or copied in part or in whole without their consent. All drawings are to be made under the supervision of the Architect.</p>	

- STUDIO UNIT**
- 1 BED ROOM**
- 3 BED ROOM**
- FIRE EXIT**
- ELEVATOR**

Republic of the Philippines
Department of Public Works
Transportation and Communication
LAPU-LAPU CITY

RECOMMENDING ISSUANCE: _____

HEAD BLDG. ARCHITECTURAL: _____ DATE: _____

ISSUED BY: _____

BUILDING OFFICIAL: _____ DATE: _____

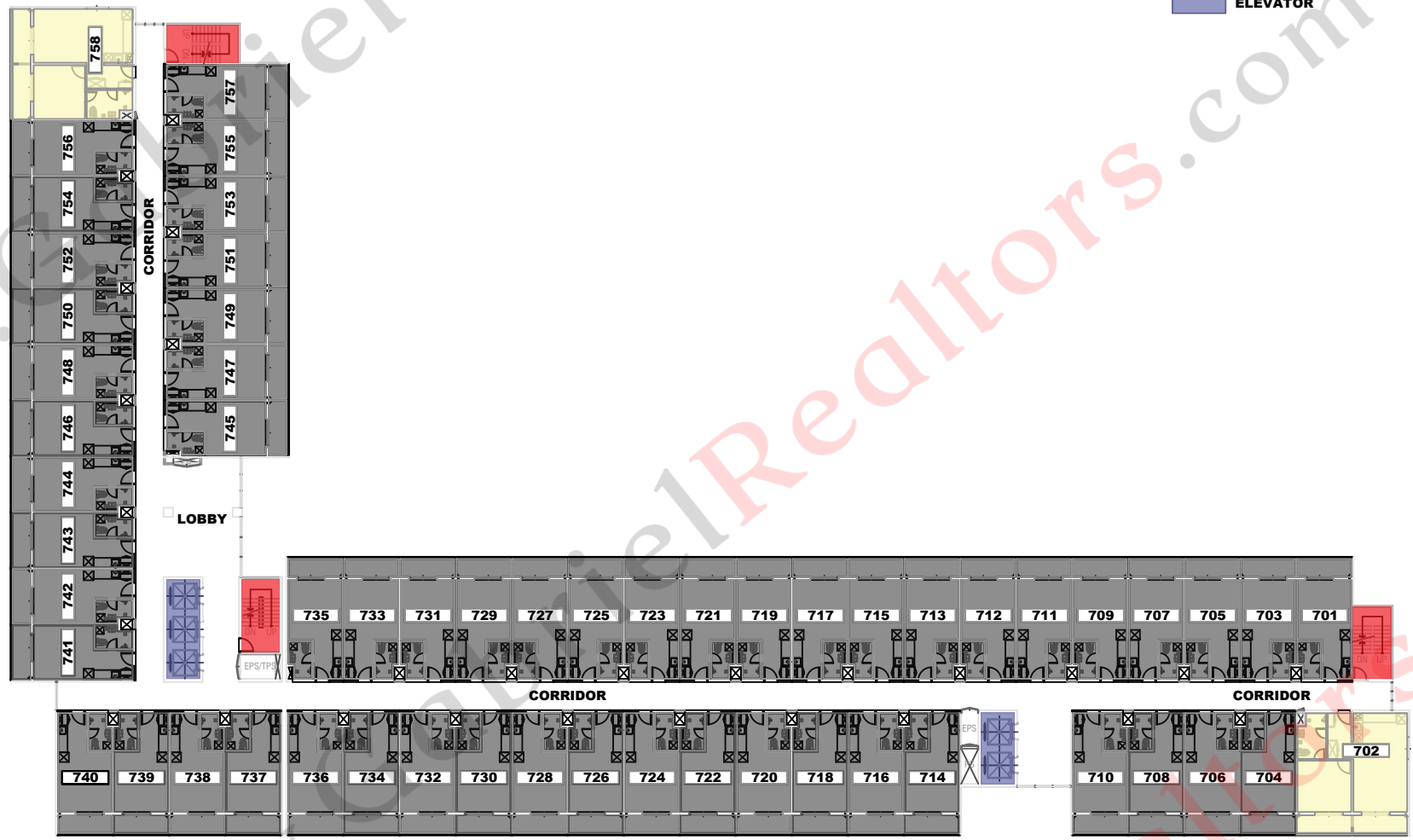

A
1401

7F PLAN (BLDG 102)
SCALE: 1/300

<p>D. DAN CEBU ARCHITECTS 502 MEZZANINE FLOOR, 615 B. ROAD, SUPERBLOCK ONE, CORONA C.I. PHOENIX, ST. CEBU CITY 6000 CONTACT NO. 031-8800000, 0903-8800000, 0903-8800000</p>	ARCHITECT DENNIS DAN T. NUÑEZ, UAP CEBU CITY		PROJECT TITLE SAEKYUNG OCEAN RESIDENCES		OWNER SKB MABUHAY REALTY CO. RAYMUND FRANCISCO		SHEET CONTENTS AS SHOWN		DESIGN DDN DATE: 2021-01		<p>PROJECT CAD LICENSE NO.: 3ARLPS-AGAU20H-0811AA-XBKAND</p>	<p>SHEET NO. A 1401</p>
	PRJ NO. : 0019753 REG. DATE: FEB. 23, 2005	PTR NO. : 696070 ISSUED ON: CEBU CITY	DATE: JAN. 06, 2021 TIN: 239-853-409-000	LOCATION: SUBA-BASBAS RD, SUBA-BASBAS, LAPU-LAPU CITY, CEBU, PHILIPPINES		SAEKYUNG 956, CALTEX RD, LAPU-LAPU CITY, CEBU, PHILIPPINES		DESIGN: DDN SCALE: AS SHOWN CHECKED: _____ DATE: _____		THIS DRAWING IS AN INSTRUMENT OF SERVICE AS A MEMBER OF THE ARCHITECTS AND IS NOT TO BE REPRODUCED OR COPIED IN PART OR IN WHOLE WITHOUT THEIR CONSENT. ALL DRAWINGS ARE TO BE MADE UNDER THE SUPERVISION OF THE ARCHITECT.		

- STUDIO UNIT**
- 1 BED ROOM**
- 3 BED ROOM**
- FIRE EXIT**
- ELEVATOR**

Republic of the Philippines
Department of Public Works
Transportation and Communication
LAPU-LAPU CITY

RECOMMENDING ISSUANCE:

HEAD BLDG. ARCHITECTURAL: _____ DATE: _____

ISSUED BY: _____

BUILDING OFFICIAL: _____ DATE: _____

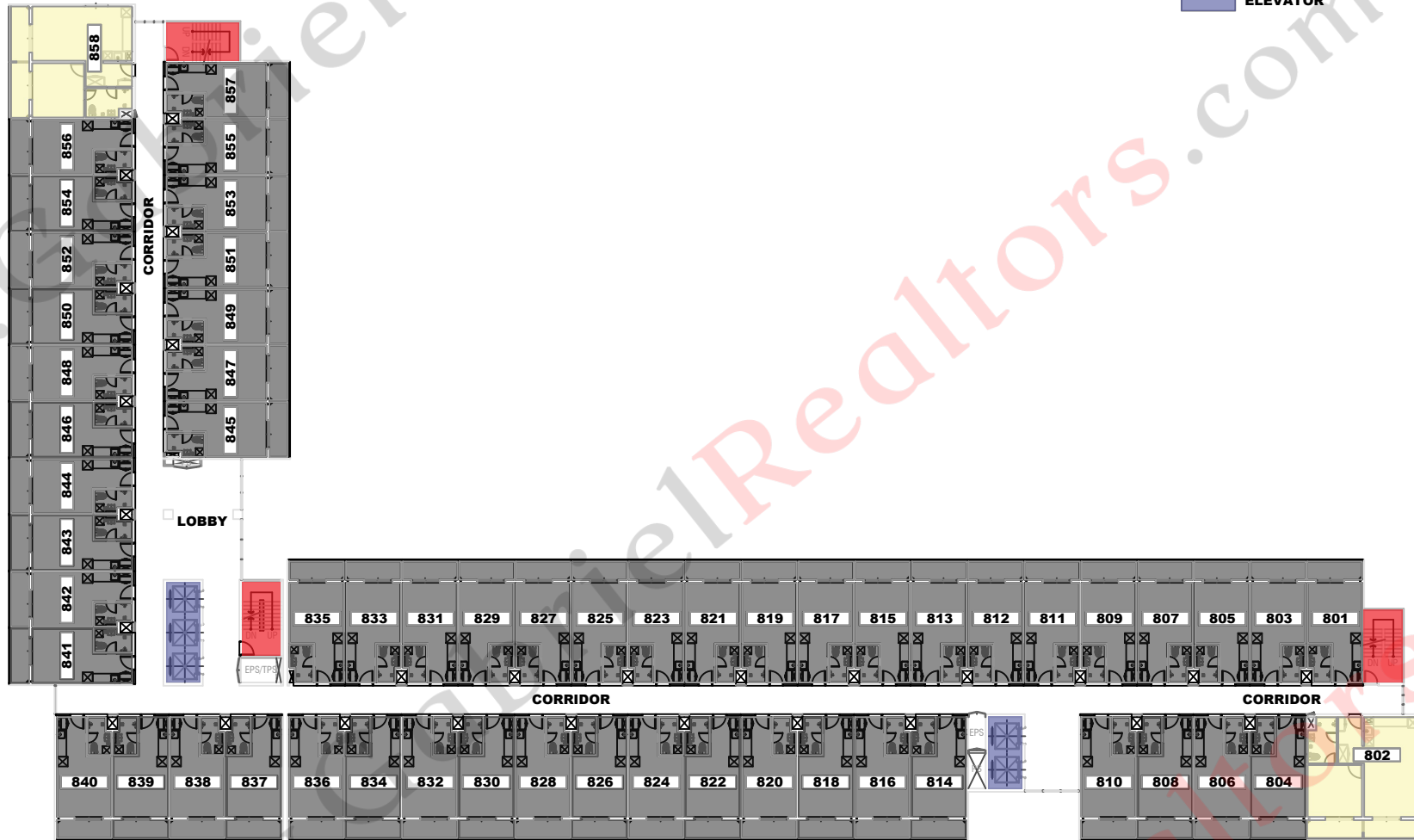

A
1401

8F PLAN (BLDG 102)
SCALE: 1/300

<p>D. DAN CEBU ARCHITECTS 502 MEZZANINE FLOOR, 415 B. ROAD, SUPERBLOCK ONE, CORNER U.S. ROAD, ST. CEBU CITY 6000 CONTACT NO. 031-8800100, 0903-8854-2100, 8854-2108</p>	ARCHITECT	PROJECT TITLE	OWNER	SHEET CONTENTS	SHEET CONTENTS	DESIGN: DDN	DATE: 2021-01	SHEET NO.
	<p>DENNIS DAN T. NUÑEZ, JAP CEBU CITY</p> <p>PRC NO. : 0019753 PTR NO. : 696070 DATE: JAN. 06, 2021</p> <p>REG. DATE: FEB. 23, 2005 ISSUED ON: CEBU CITY TIN: 239-853-409-000</p>	<p>SAEKYUNG OCEAN RESIDENCES</p> <p>LOCATION: SUBA-BASBAS RD, SUBA-BASBAS, LAPU-LAPU CITY, CEBU, PHILIPPINES</p>	<p>SKB MABUHAY REALTY CO. RAYMUND FRANCISCO</p> <p>SAEKYUNG 956, CALTEX RD, LAPU-LAPU CITY, CEBU, PHILIPPINES</p>	<p>AS SHOWN</p>	<p>AS SHOWN</p>	<p>LOAD BY: DDN CHECKED: _____</p> <p>SCALE: AS SHOWN</p> <p>PROJECT/CD LICENSE NO.: 3ARLPS-AGAZ02H-0811AA-XBKAND</p>	<p>2021-01</p>	<p>A 1401</p>

- STUDIO UNIT**
- 1 BED ROOM**
- 3 BED ROOM**
- FIRE EXIT**
- ELEVATOR**

Republic of the Philippines
Department of Public Works
Transportation and Communication
LAPU-LAPU CITY

RECOMMENDING ISSUANCE: _____

HEAD BLDG. ARCHITECTURAL: _____ DATE: _____

ISSUED BY: _____

BUILDING OFFICIAL: _____ DATE: _____

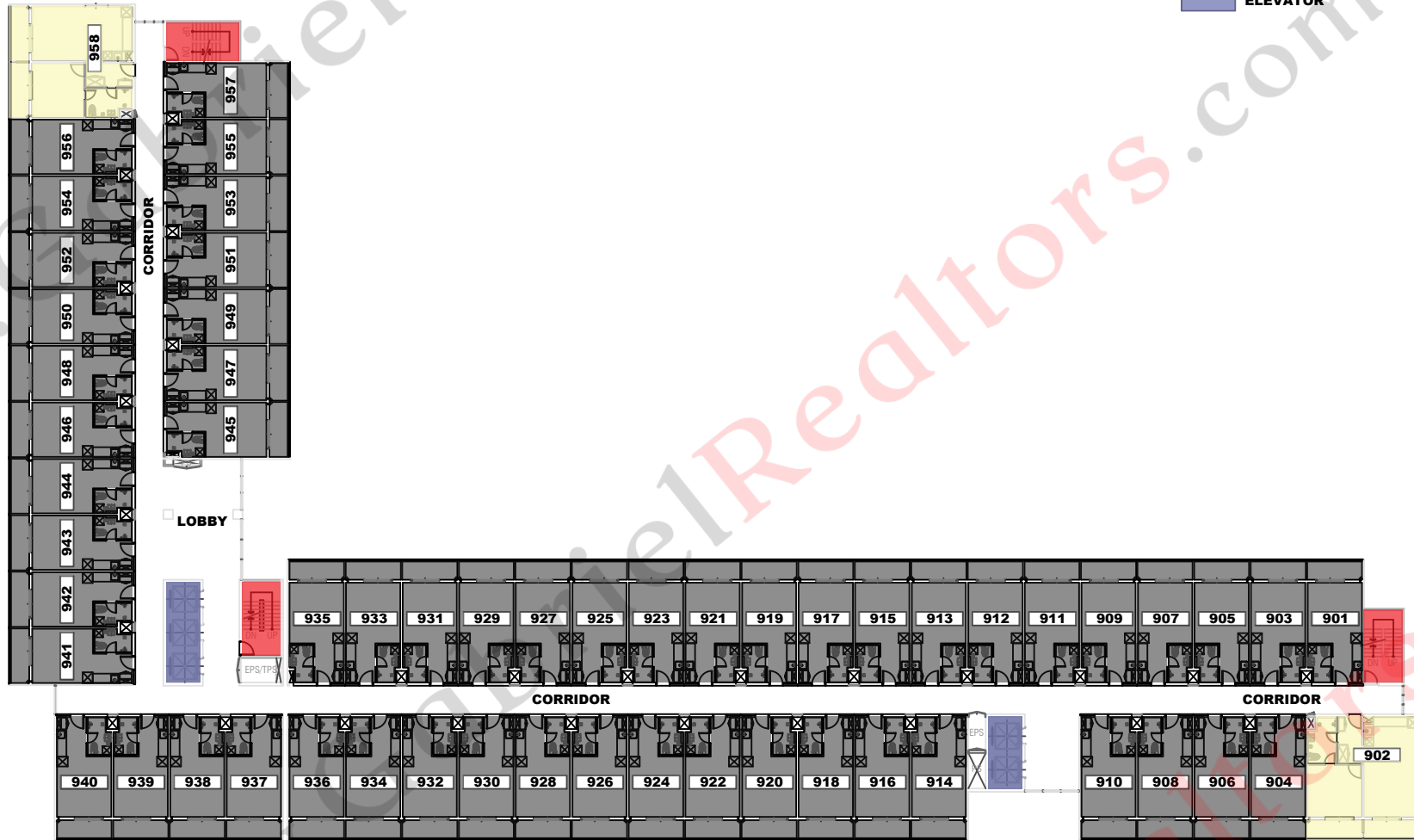

A
1401

9F PLAN (BLDG 102)
SCALE: 1/300

<p>cebu architects DESIGN + BUILD</p> <p>D. DAN CEBU ARCHITECTS 502 MEZZANINE FLOOR, 615 B. ROAD, SUPERBLOCK ONE, CORNELIUS P. ROSA, JR. CEBU CITY 6000 CONTACT NO. 031-5000-0000 (09:00 AM - 05:00 PM) WWW.CEBUARCHITECTS.COM</p>	<p>ARCHITECT</p> <p>DENNIS DAN T. NUÑEZ, JAP CEBU CITY</p>	<p>PROJECT TITLE</p> <p>SAEKYUNG OCEAN RESIDENCES</p>	<p>OWNER</p> <p>SKB MABUHAY REALTY CO. RAYMUND FRANCISCO</p>	<p>SHEET CONTENTS</p> <p>AS SHOWN</p>	<p>SHEET CONTENTS</p> <p>AS SHOWN</p>	<p>DESIGN: DDN</p> <p>DATE: 2021-01</p> <p>CHECKED: _____</p>	<p>SHEET NO.</p> <p>A 1401</p>
	<p>PRC NO. : 0019753</p> <p>REG. DATE: FEB. 23, 2005</p>	<p>PTR NO. : 696070</p> <p>ISSUED ON: CEBU CITY</p>	<p>DATE: JAN. 06, 2021</p> <p>TIN: 239-853-409-000</p>	<p>LOCATION: SUBA-BASBAS RD, SUBA-BASBAS, LAPU-LAPU CITY, CEBU, PHILIPPINES</p>	<p>SAEKYUNG 956, CALTEX RD, LAPU-LAPU CITY, CEBU, PHILIPPINES</p>	<p>PROFESSIONAL LICENSE NO. : 348LPS-AGAU20H-0811A-A-XBKAND</p>	<p>DESIGNER'S DECLARATION: I, the undersigned, certify that I am a duly registered Professional Architect in the Philippines and I am the author of the design shown on this drawing. I am not aware of any other person who has contributed to the design shown on this drawing.</p>

- STUDIO UNIT (CITY VIEW)**
- STUDIO UNIT (SEA VIEW)**
- 1 BED ROOM**
- 3 BED ROOM**
- FIRE EXIT**
- ELEVATOR**

Republic of the Philippines
Department of Public Works
Transportation and Communication
LAPU-LAPU CITY

RECOMMENDING ISSUANCE:

HEAD BLDG. ARCHITECTURAL: _____ DATE: _____

ISSUED BY: _____

BUILDING OFFICIAL: _____ DATE: _____

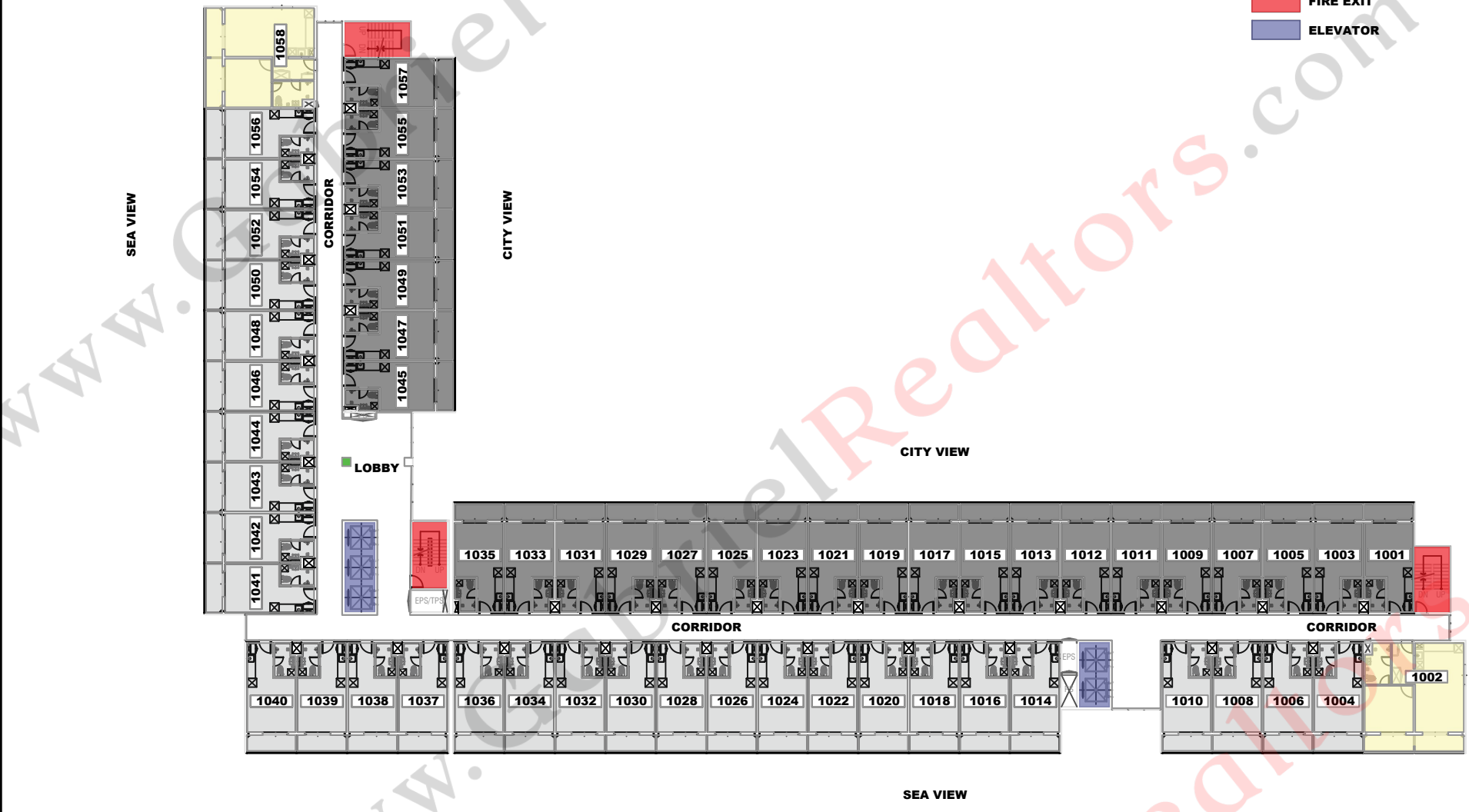

A
1401

10F PLAN (BLDG 102)
SCALE: 1/300

	ARCHITECT	PROJECT TITLE	OWNER	SHEET CONTENTS	SHEET CONTENTS	DESIGN: DDN	DATE: 2021-01	SHEET NO.
	DENNIS DAN T. NUÑEZ, JAP CEBU CITY	SAEKYUNG OCEAN RESIDENCES	SKB MABUHAY REALTY CO. RAYMUND FRANCISCO SAEKYUNG 956 CALTEX RD. LAPU-LAPU CITY, CEBU, PHILIPPINES	AS SHOWN	AS SHOWN	DDN CHECKED:	DATE: 2021-01	A 1401
D. DAN CEBU ARCHITECTS 502 MEZZANINE FLOOR, 615 BERMAL DRIVE, SUBA-BASBAS, CEBU CITY 6000 CONTACT NO. 031-8900100, 0905-888-8888, 0917-888-8888 WWW.CEBUARCHITECTS.COM	PRC NO. : 0019753 PTR NO. : 696070 DATE: JAN. 06, 2021 REG. DATE: FEB. 23, 2005 ISSUED ON: CEBU CITY TIN: 239-853-409-000	LOCATION: SUBA-BASBAS RD, SUBA-BASBAS, LAPU-LAPU CITY, CEBU, PHILIPPINES	PROJECT LICENSE NO. : 3ARLPS-AGAL20H-0811AA-XBKAND This drawing is an instrument of service as a member of the Architect and/or civil engineer is considered as signed in part or in whole without their consent. All drawings are to be used under license only.	This drawing is copyright. Construction shall reflect all dimensions on this page. Signed conditions are to be worked on. Discrepancies must be reported to the Architect before starting.				

- STUDIO UNIT (CITY VIEW)**
- STUDIO UNIT (SEA VIEW)**
- 1 BED ROOM**
- 3 BED ROOM**
- FIRE EXIT**
- ELEVATOR**

Republic of the Philippines
Department of Public Works
Transportation and Communication
LAPU-LAPU CITY

RECOMMENDING ISSUANCE: _____

HEAD BLDG. ARCHITECTURAL: _____ DATE: _____

ISSUED BY: _____

BUILDING OFFICIAL: _____ DATE: _____

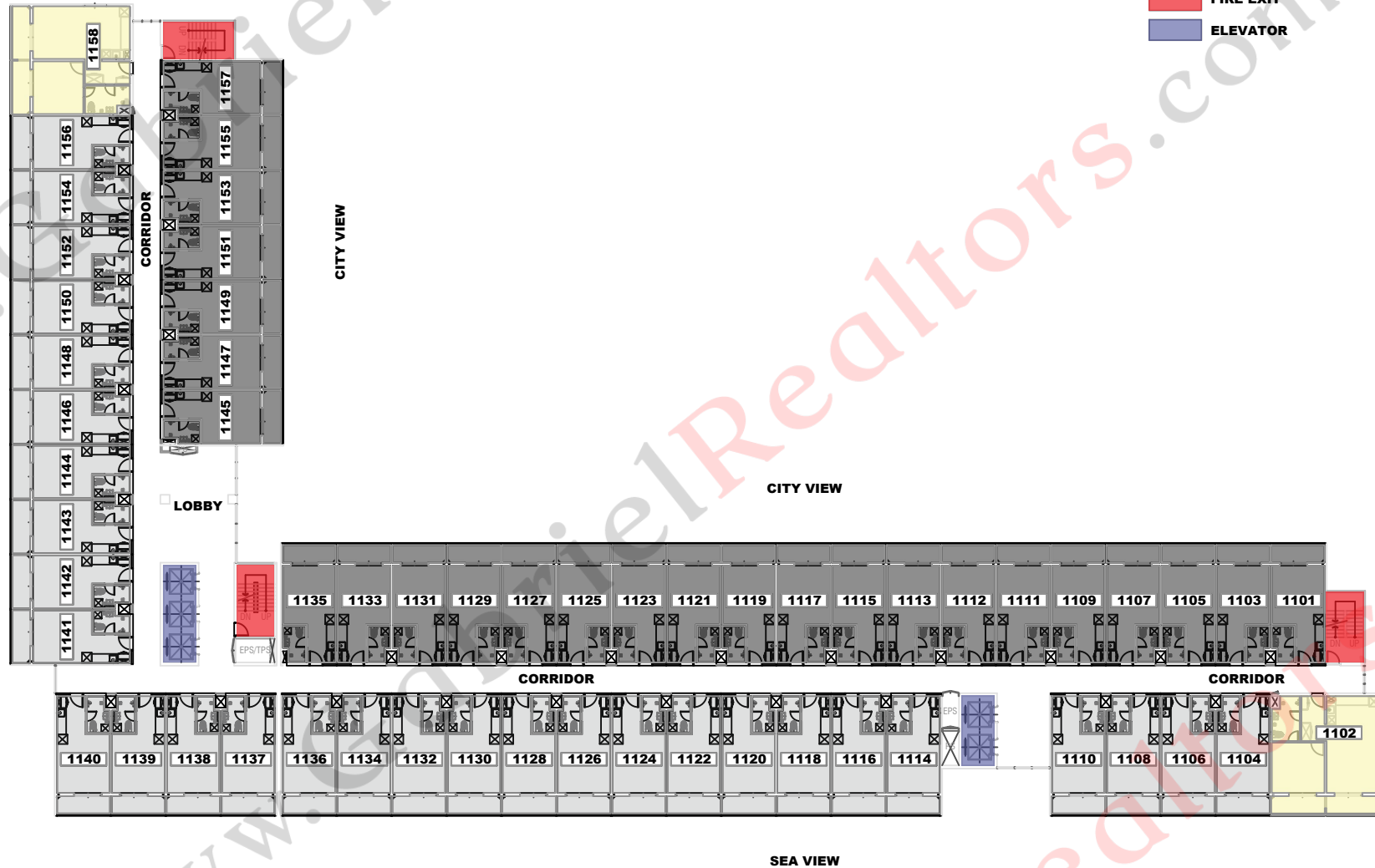

A
1401

11F PLAN (BLDG 102)

SCALE: 1/300

<p>ARCHITECT</p> <p style="text-align: center;">DENNIS DAN T. NUÑEZ, JAP</p> <p style="text-align: center;">CEBU CITY</p>	<p>PROJECT TITLE</p> <p style="text-align: center;">SAEKYUNG OCEAN RESIDENCES</p>	<p>OWNER</p> <p style="text-align: center;">SKB MABUHAY REALTY CO. RAYMUND FRANCISCO</p>	<p>SHEET CONTENTS</p> <p style="text-align: center;">AS SHOWN</p>	<p>DESIGN: DDN</p> <p>DATE: 2021-01</p> <p>CHECKED: _____</p>	<p>SHEET NO.</p> <p style="text-align: center;">A 1401</p>
<p>D. DAN CEBU ARCHITECTS</p> <p>MEZANINE FLOOR, 415 BERMUNDO AVENUE, CORNER U.S. ROAD, ST. CEBU CITY 6000</p> <p>CONTACT NO. 0533900000, 0905339000, 0905339001</p> <p>WWW.CEBUARCHITECTS.COM</p>	<p>PRC NO. - 0019753 PTR NO. - 696070 DATE: JAN. 06, 2021</p> <p>REG. DATE: FEB. 23, 2005 ISSUED ON: CEBU CITY TIN: 239-853-409-000</p>	<p>LOCATION: SUBA-BASBAS RD, SUBA-BASBAS, LAPU-LAPU CITY, CEBU, PHILIPPINES</p>	<p>LOCATION: SAEKYUNG 956, CALTEX RD, LAPU-LAPU CITY, CEBU, PHILIPPINES</p>	<p>PROJECT CAD LICENSE NO.: 3ARLPS-AGAZ2N-0B11AA-XBKAND</p> <p>The drawings are an instrument of service in compliance with the Architect Act and shall remain the property of the Architect and shall not be reproduced or copied in part or in whole without their consent. All drawings are to be used under license only.</p>	

- STUDIO UNIT (CITY VIEW)**
- STUDIO UNIT (SEA VIEW)**
- 1 BED ROOM**
- 3 BED ROOM**
- FIRE EXIT**
- ELEVATOR**

Republic of the Philippines
Department of Public Works
Transportation and Communication
LAPU-LAPU CITY

RECOMMENDING ISSUANCE:

HEAD BLDG. ARCHITECTURAL: _____ DATE: _____

ISSUED BY: _____

BUILDING OFFICIAL: _____ DATE: _____

SEA VIEW

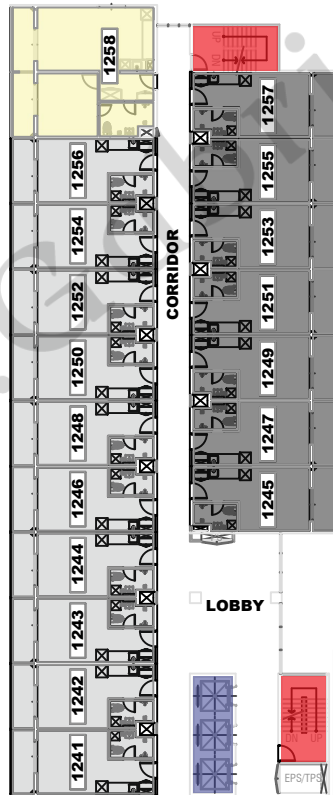

CORRIDOR

CITY VIEW

CITY VIEW

LOBBY

EPS/TPS

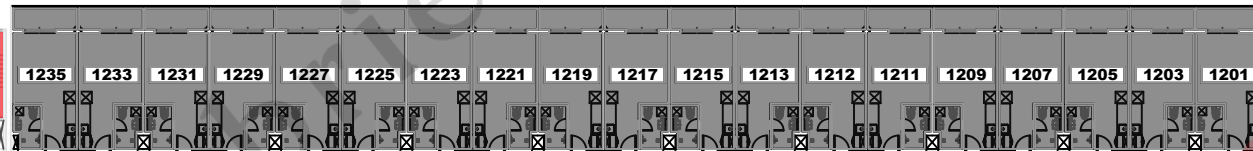

CORRIDOR

CORRIDOR

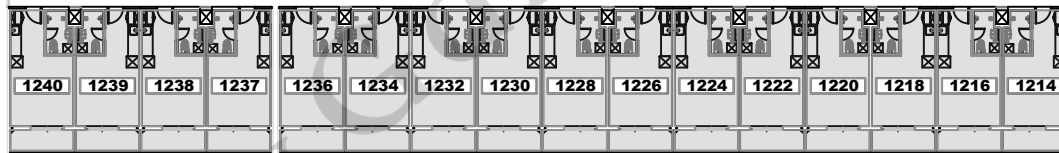

SEA VIEW



12F PLAN (BLDG 102)

SCALE: 1/300

- STUDIO UNIT (CITY VIEW)**
- STUDIO UNIT (SEA VIEW)**
- 1 BED ROOM**
- 3 BED ROOM**
- FIRE EXIT**
- ELEVATOR**

Republic of the Philippines
Department of Public Works
Transportation and Communication
LAPU-LAPU CITY

RECOMMENDING ISSUANCE:

HEAD BLDG. ARCHITECTURAL: _____ DATE: _____

ISSUED BY: _____

BUILDING OFFICIAL: _____ DATE: _____

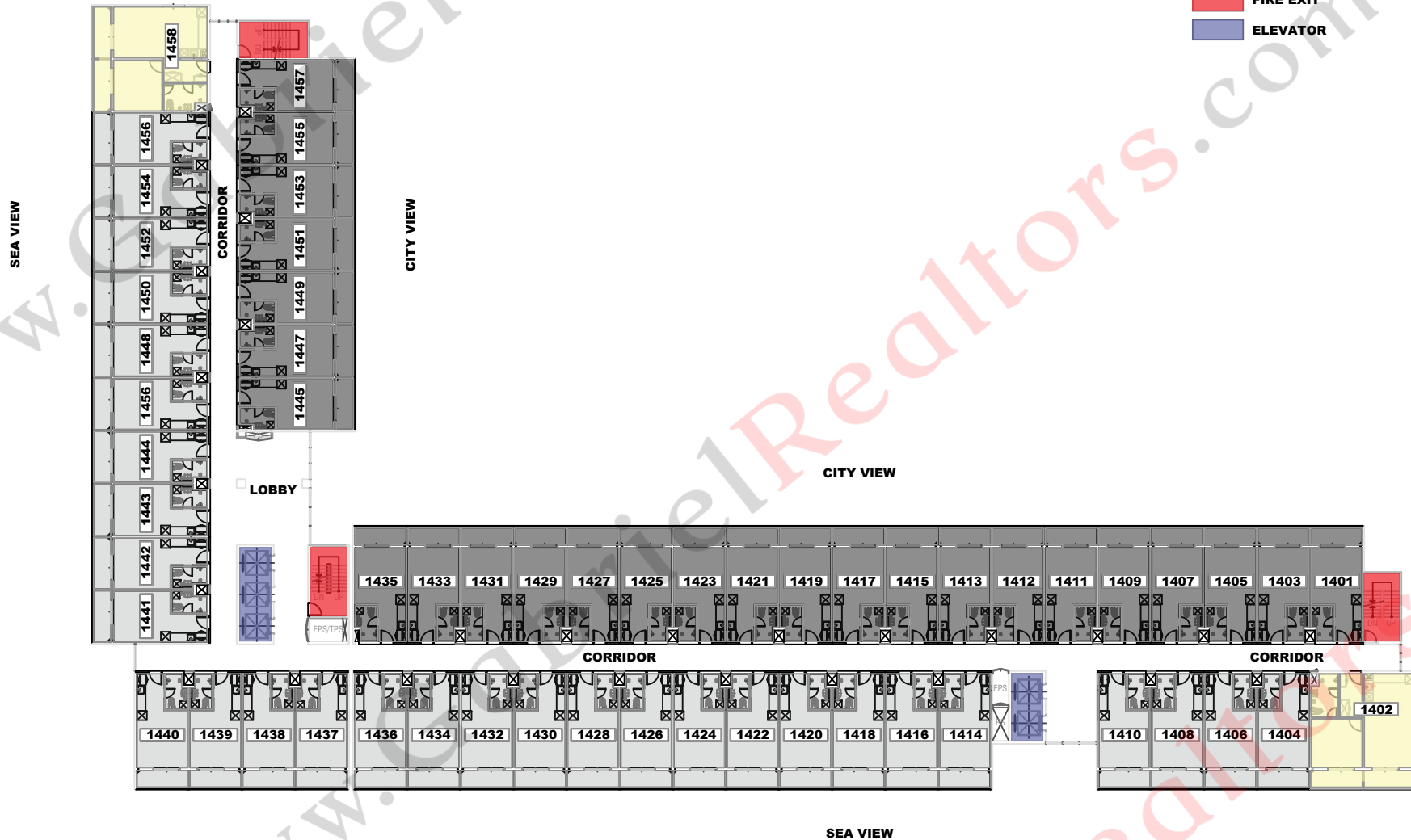

A
1401

14F PLAN (BLDG 102)
SCALE: 1/300

- STUDIO UNIT (CITY VIEW)**
- STUDIO UNIT (SEA VIEW)**
- 1 BED ROOM**
- 3 BED ROOM**
- FIRE EXIT**
- ELEVATOR**

Republic of the Philippines Department of Public Works Transportation and Communication LAPU-LAPU CITY	
RECOMMENDING ISSUANCE:	
HEAD BLDG. ARCHITECTURAL:	DATE:
ISSUED BY:	
BUILDING OFFICIAL:	DATE:

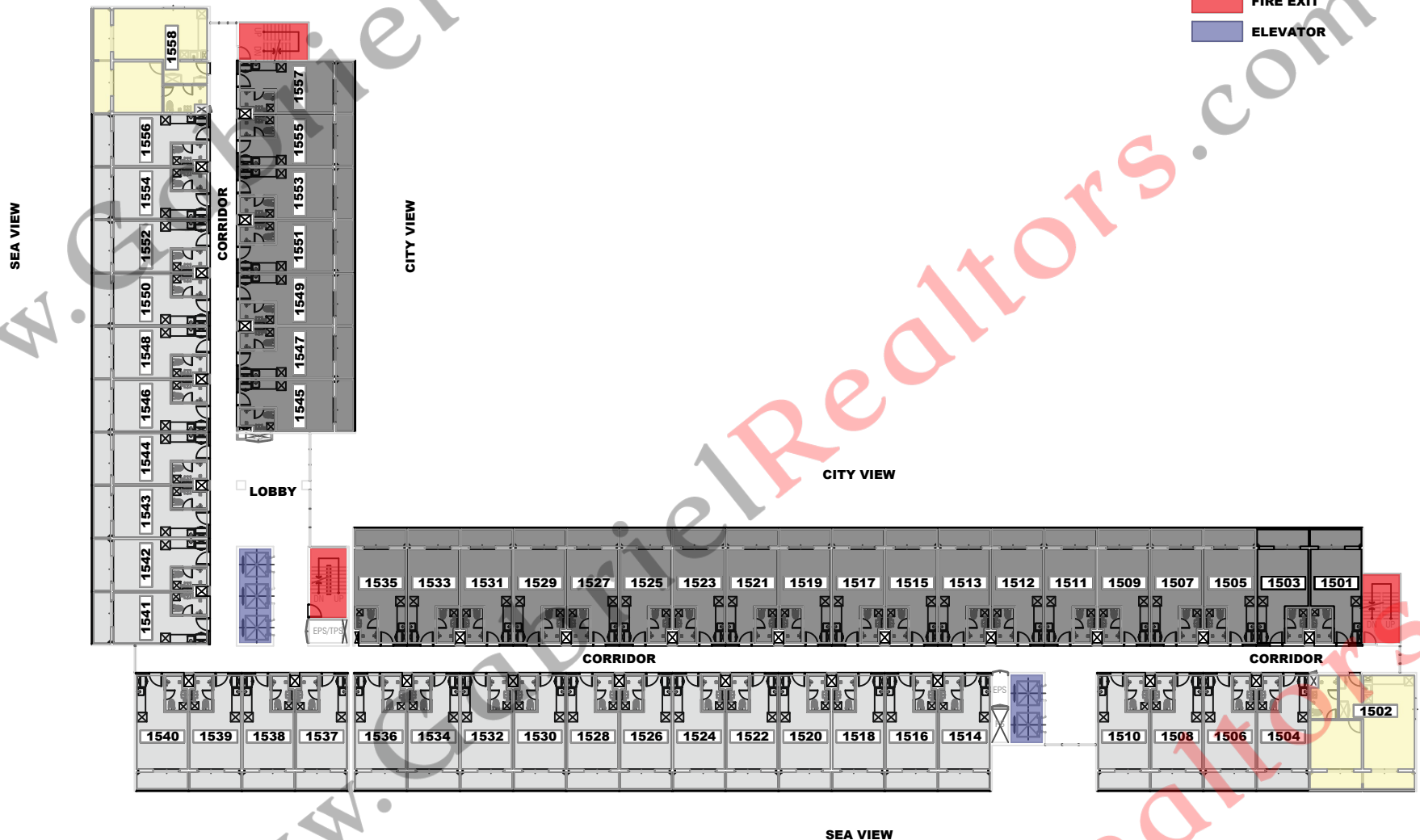

A
1401

15F PLAN (BLDG 102)
SCALE: 1/300

	ARCHITECT	PROJECT TITLE	OWNER	SHEET CONTENTS	SHEET CONTENTS	DESIGN: DDN	DATE: 2021-01	SHEET NO.
	DENNIS DAN T. NUÑEZ, JAP CEBU CITY	SAEKYUNG OCEAN RESIDENCES	SKB MABUHAY REALTY CO. RAYMUND FRANCISCO	AS SHOWN	AS SHOWN	LOAD BY: DDN	CHECKED:	A 1401
D. DAN CEBU ARCHITECTS 502 MEZZANINE FLOOR, 615 B. ROAD, SUPERBLOCK ONE, CORNER U.S. ROAD, ST. CEBU CITY 6000 CONTACT NO. 031-8900100, 0903-8888-8888, 0917-486-8888 WWW.CEBUARCHITECTS.COM	PRC NO. : 0019753 PTR NO. : 696070 DATE: JAN. 06, 2021	LOCATION: SUBA-BASBAS RD, SUBA-BASBAS, LAPU-LAPU CITY, CEBU, PHILIPPINES	SAEKYUNG 956, CALTEX RD, LAPU-LAPU CITY, CEBU, PHILIPPINES			This drawing is an instrument of service as a member of the Architect and/or civil engineer is considered as signed in part or in whole without their consent. All drawings are to be used under the supervision of the architect.		
REG. DATE: FEB. 23, 2005 ISSUED ON: CEBU CITY	TIN: 239-853-409-000							

- STUDIO UNIT (CITY VIEW)**
- STUDIO UNIT (SEA VIEW)**
- 1 BED ROOM**
- 3 BED ROOM**
- FIRE EXIT**
- ELEVATOR**

Republic of the Philippines
Department of Public Works
Transportation and Communication
LAPU-LAPU CITY

RECOMMENDING ISSUANCE: _____

HEAD BLDG. ARCHITECTURAL: _____ DATE: _____

ISSUED BY: _____

BUILDING OFFICIAL: _____ DATE: _____

SEA VIEW

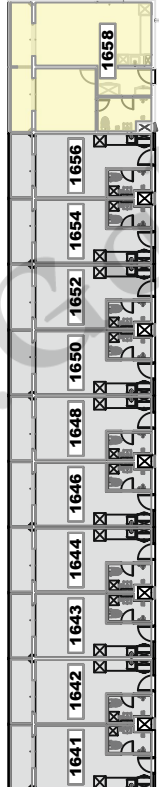

CORRIDOR

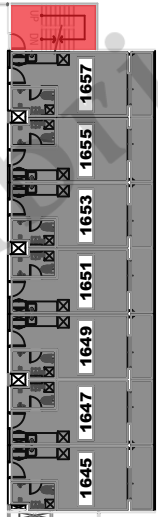

CITY VIEW

CITY VIEW

LOBBY

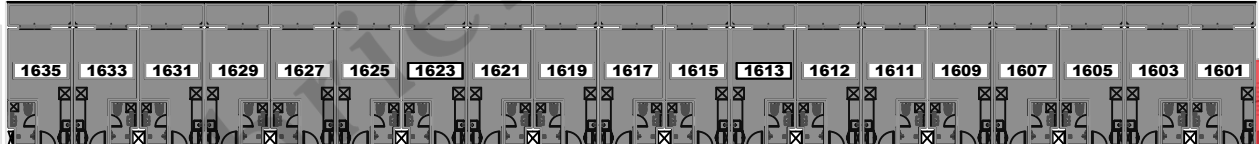

CORRIDOR

CORRIDOR



SEA VIEW

A
1401

16F PLAN (BLDG 102)
SCALE: 1/300

<p>ARCHITECT</p> <p style="text-align: center;">DENNIS DAN T. NUÑEZ, JAP</p> <p style="text-align: center;">CEBU CITY</p>	<p>PROJECT TITLE</p> <p style="text-align: center;">SAEKYUNG OCEAN RESIDENCES</p>	<p>OWNER</p> <p style="text-align: center;">SKB MABUHAY REALTY CO. RAYMUND FRANCISCO</p>	<p>SHEET CONTENTS</p> <p>AS SHOWN</p>	<p>DESIGN: DDN DATE: 2021-01</p> <p>DRAWN BY: DDN CHECKED: _____</p> <p>SCALE: AS SHOWN</p> <p>PROJECT LICENSE NO.: 3ARLPS-AGAU2H-0B11AA-XBKAND</p>	<p>SHEET NO.</p> <p style="text-align: center;">A 1401</p>
<p>D. DAN CEBU ARCHITECTS</p> <p>502 MEZZANINE FLOOR, 655 B. ROAD, SUPERBLOCK ONE, CORNER U.S. ROAD, ST. CEBU CITY 6000</p> <p>CONTACT NO. 05330001000-05330001000-05330001000</p> <p>WWW.CEBUARCHITECTS.COM</p>	<p>PRC NO. : 0019753 PTR NO. : 696070 DATE: JAN. 06, 2021</p> <p>REG. DATE: FEB. 23, 2005 ISSUED ON: CEBU CITY TIN: 239-853-409-000</p>	<p>LOCATION: SUBA-BASBAS RD, SUBA-BASBAS, LAPU-LAPU CITY, CEBU, PHILIPPINES</p>	<p>SAEKYUNG 956, CALTEX RD, LAPU-LAPU CITY, CEBU, PHILIPPINES</p>	<p>The drawings are the intellectual property of the Architect and shall remain confidential and not to be used, copied, reproduced or otherwise disseminated without the written consent of the Architect.</p>	

- STUDIO UNIT (CITY VIEW)**
- STUDIO UNIT (SEA VIEW)**
- 1 BED ROOM**
- 3 BED ROOM**
- FIRE EXIT**
- ELEVATOR**

Republic of the Philippines
Department of Public Works
Transportation and Communication
LAPU-LAPU CITY

RECOMMENDING ISSUANCE:

HEAD BLDG. ARCHITECTURAL: _____ DATE: _____

ISSUED BY: _____

BUILDING OFFICIAL: _____ DATE: _____

SEA VIEW

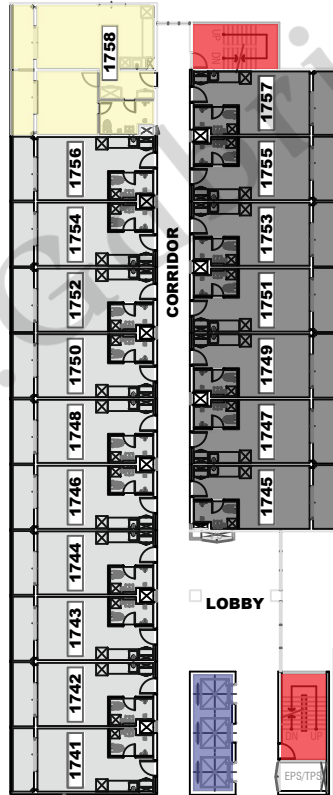

CORRIDOR

CITY VIEW

CITY VIEW

LOBBY

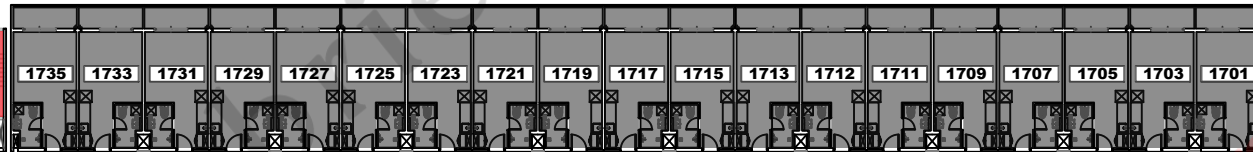
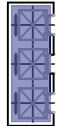

CORRIDOR

CORRIDOR

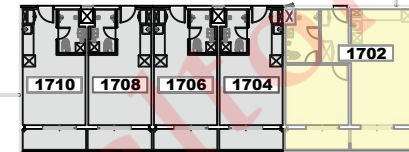
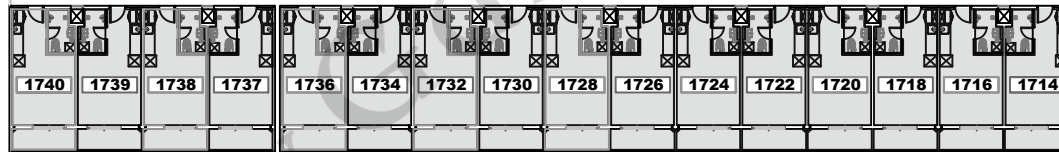

SEA VIEW

A
1401

17F PLAN (BLDG 102)

SCALE: 1/300

<p>ARCHITECT</p> <p>DENNIS DAN T. NUÑEZ, UAP</p> <p>CEBU CITY</p>	<p>PROJECT TITLE</p> <p>SAEKYUNG OCEAN RESIDENCES</p>	<p>OWNER</p> <p>SKB MABUHAY REALTY CO. RAYMUND FRANCISCO</p>	<p>SHEET CONTENTS</p>	<p>SHEET CONTENTS</p> <p>AS SHOWN</p>	<p>DESIGN: DDN</p>	<p>DATE: 2021-01</p>	<p>SHEET NO.</p> <p>A 1401</p>
					<p>ADD BY: DDN</p>	<p>CHECKED:</p>	
<p>D. DAN CEBU ARCHITECTS</p> <p>502 MEZZANINE FLOOR, 215 B. ROAD, SUPERBLOCK ONE, CORNER U.S. POSTAL ST., CEBU CITY 6000</p> <p>CONTACT NO. 05330001000-05330001000-05330001000</p> <p>WWW.CEBUARCHITECTS.COM</p>	<p>PRC NO. : 0019753</p> <p>PTR NO. : 696070</p> <p>DATE: JAN. 06, 2021</p> <p>REG. DATE: FEB. 23, 2005</p> <p>ISSUED ON: CEBU CITY</p> <p>TIN: 239-853-409-000</p>	<p>LOCATION: SUBA-BASBAS RD, SUBA-BASBAS, LAPU-LAPU CITY, CEBU, PHILIPPINES</p>	<p>SAEKYUNG 956, CALTEX RD, LAPU-LAPU CITY, CEBU, PHILIPPINES</p>	<p>AS SHOWN</p>	<p>DESIGN: DDN</p> <p>DATE: 2021-01</p>	<p>SHEET NO.</p> <p>A 1401</p>	

- STUDIO UNIT (CITY VIEW)**
- STUDIO UNIT (SEA VIEW)**
- 1 BED ROOM**
- 3 BED ROOM**
- FIRE EXIT**
- ELEVATOR**

Republic of the Philippines
Department of Public Works
Transportation and Communication
LAPU-LAPU CITY

RECOMMENDING ISSUANCE:

HEAD BLDG. ARCHITECTURAL: _____ DATE: _____

ISSUED BY: _____

BUILDING OFFICIAL: _____ DATE: _____

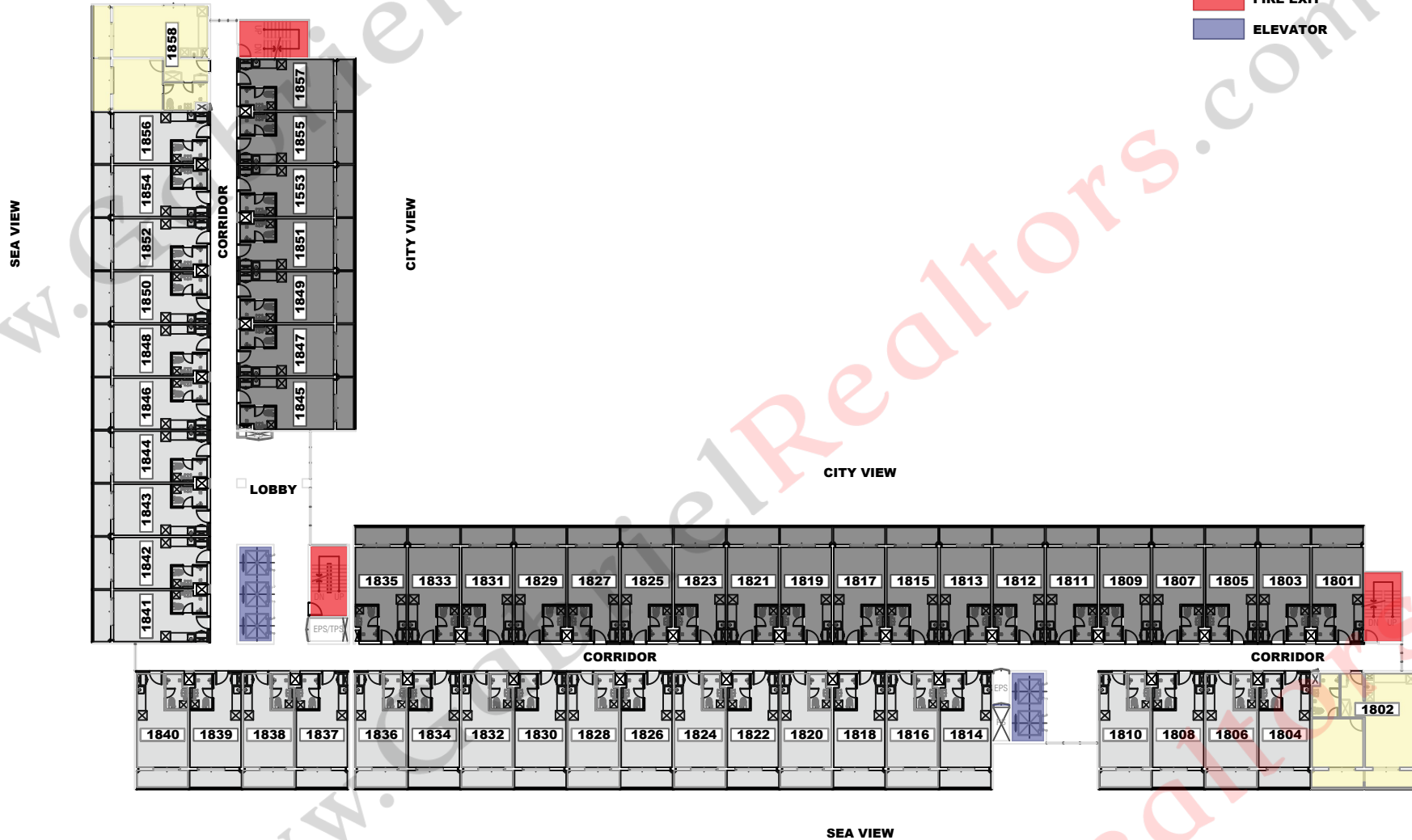

A
1401

18F PLAN (BLDG 102)
SCALE: 1/300