

The logo for BREEZA scapes, featuring a blue wavy line above the word 'BREEZA' in a bold, blue, sans-serif font, with 'scapes' in a smaller, blue, lowercase font below it.

CONTACT US



(+63) 943 312 5445
(+63) 995 101 9010



gabrielrealty101@gmail.com
cocoytoledo@gabrielrealtors.com

www.GabrielRealtors.com







50 homes in 1.05 hectares

Location

Locata Road, Brgy. Looc, Lapu-Lapu City



Site Development Plan

	Single Attached A	31 units
	Single Attached B	3 units
	Duplex A	8 units
	Duplex B	8 units
	Total Units	50 units





Our Amenities



Clubhouse

Park and Playground





Pool



Our Homes



Nelson
DUPLEX



Ground Floor

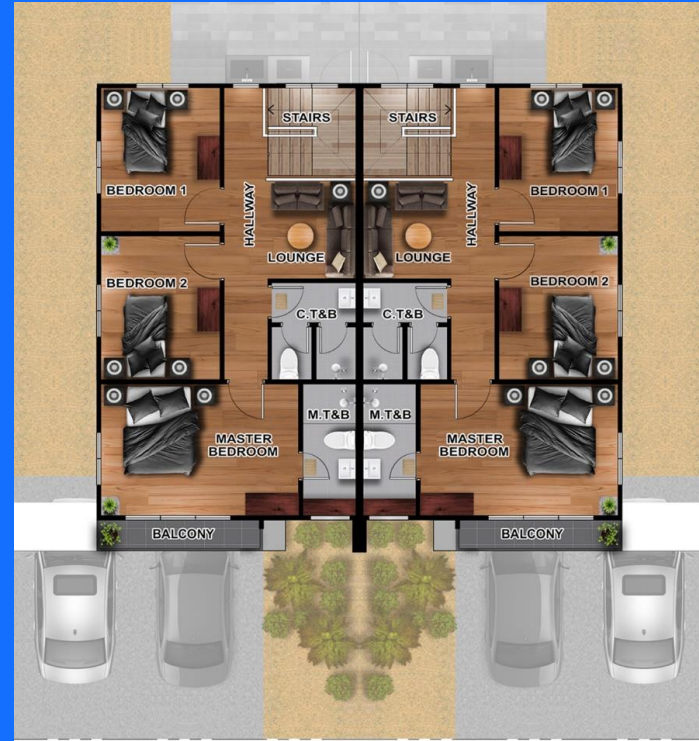

Second Floor

Nelson

DUPLEX

Floor Area: 157.72 sq. m.
 Total Lot Area: 136 sq. m.

Master Bedroom w/ Balcony,
 2 Bedrooms, Living Area, Dining
 Area, Kitchen, Master's T&B,
 Common T&B, Comfort Room,
 Guest Room, Service Area,
 Garden, 2-car Carport



Nelson
Single Attached

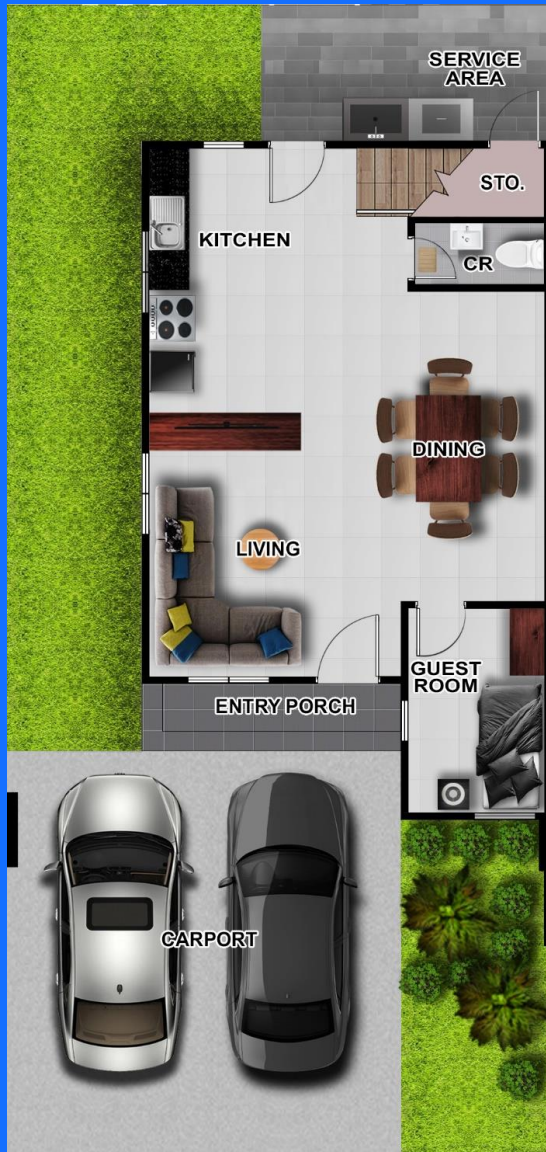

Ground Floor

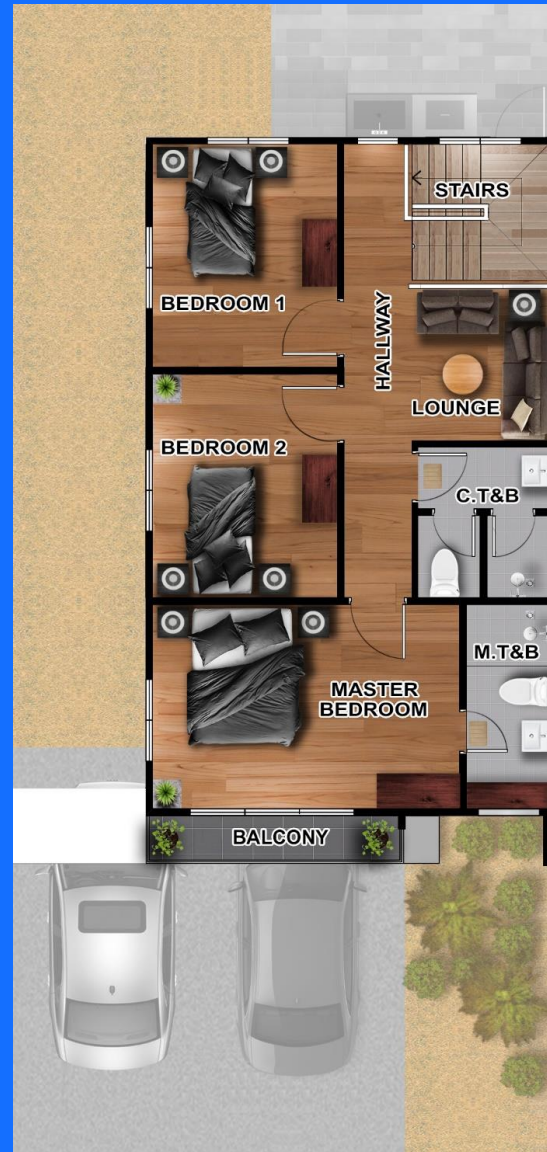

Second Floor

Nelson

SINGLE ATTACHED

Floor Area: 157.72 sq. m.

Total Lot Area: 136 sq. m.

Master Bedroom w/ Balcony,
 2 Bedrooms, Living Area, Dining
 Area, Kitchen, Master's T&B,
 Common T&B, Comfort Room,
 Guest Room, Service Area,
 Garden, 2-car Carport



Andrew
DUPLEX



Ground Floor



Second Floor

Andrew

DUPLEX

Floor Area: 133.83 sq. m.

Total Lot Area: 101.25 sq. m.

Master Bedroom w/ Balcony,
 2 Bedrooms, Living Area, Dining
 Area, Kitchen, Master's T&B,
 Common T&B, Comfort Room,
 Guest Room, Service Area,
 Garden, 2-car Carport



Andrew
Single Attached



Ground Floor



Second Floor

Andrew

SINGLE ATTACHED

Floor Area: 133.83 sq. m.

Total Lot Area: 101.25 sq. m.

Master Bedroom w/ Balcony,
 2 Bedrooms, Living Area, Dining
 Area, Kitchen, Master's T&B,
 Common T&B, Comfort Room,
 Guest Room, Service Area,
 Garden, 2-car Carport

Master Bedroom





Bedroom 2

Living Area



A modern dining and kitchen area. The dining table is dark with a reflective surface, surrounded by six grey upholstered chairs with wooden legs. In the background, there is a kitchen island with a marble countertop and wooden base, with two white spherical pendant lights hanging above it. To the left, a large TV is mounted on a white wall with a wooden console below it. The floor is light-colored tile, and the walls are a mix of wood paneling and light-colored textured wallpaper. A large white cloud-like graphic is overlaid on the right side of the image.

*Dining and
Kitchen Area*

PRILAND Advantage

Where others cut corners, Priland delivers. Fixtures that support ease of connectivity and convenience come standard in every project.

PROVISIONS FOR:

- Provisions for Aircon
- Provisions for Telephone
- Provisions for Cable
- Provisions for LPG
- Provisions for Rangehood





PRILAND
HOMES

Building Aspirations to Life