

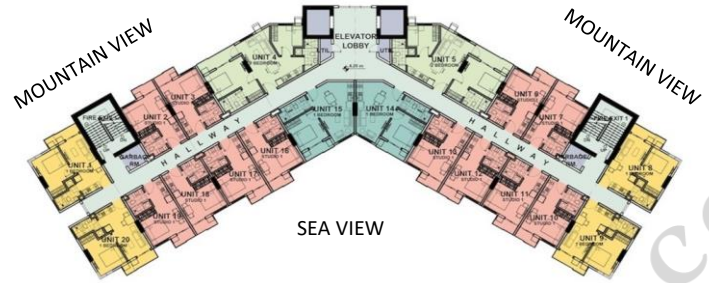

ANTARA 1 Inventory



TYPICAL FLOOR PLAN

| FLOOR | Mountain View | | | | | | | | | | Sea View | | | | | | | | | | | |
|----------|---------------|-------------|-------------|----------------|--------------|----------------|--------------|-------------|-------------|--------------|--------------|--------------|--------------|--------------|--------------|---------------|---------------|--------------|--------------|---------------|--------------|---------------|
| | UNIT NUMBER | | | | | | | | | | | | | | | | | | | | | |
| 1st Flr. | 1 1-BR | 2 STUDIO | 3 STUDIO | 4S STUDIO | 4B 1-BR-C | 5S STUDIO | 5B 1-BR-C | 6 STUDIO | 7 STUDIO | 8 1-BR | 9 1-BR | 10 STUDIO | 11 STUDIO | 12 STUDIO | 13 STUDIO | 14 STUDIO | 15 STUDIO | 16 STUDIO | 17 STUDIO | 18 1-BR(A) | | |
| 2nd Flr. | 1 1-BR | 2 STUDIO | 3 STUDIO | 4S STUDIO | 4B 1-BR-C | 5B 1-BR-C | 5S STUDIO | 6 STUDIO | 7 STUDIO | 8 1-BR(A) | 9 1-BR(A) | 10 STUDIO | 11 STUDIO | 12 STUDIO | 13 STUDIO | 14 1-BR(B) | 15 1-BR(B) | 16 STUDIO | 17 STUDIO | 18 STUDIO | 19 STUDIO | 20 1-BR(A) |
| 3rd Flr. | 1 1-BR | 2 STUDIO | 3 STUDIO | 4 2 BEDROOM | | 5 2 BEDROOM | | 6 STUDIO | 7 STUDIO | 8 1-BR(A) | 9 1-BR(A) | 10 STUDIO | 11 STUDIO | 12 STUDIO | 13 STUDIO | 14 1-BR(B) | 15 1-BR(B) | 16 STUDIO | 17 STUDIO | 18 STUDIO | 19 STUDIO | 20 1-BR(A) |
| 4th Flr. | 1 1-BR | 2 STUDIO | 3 STUDIO | 4S STUDIO | 4B 1-BR-C | 5B 1-BR-C | 5S STUDIO | 6 STUDIO | 7 STUDIO | 8 1-BR(A) | 9 1-BR(A) | 10 STUDIO | 11 STUDIO | 12 STUDIO | 13 STUDIO | 14 1-BR(B) | 15 1-BR(B) | 16 STUDIO | 17 STUDIO | 18 STUDIO | 19 STUDIO | 20 1-BR(A) |
| 5th Flr. | 1 1-BR | 2 STUDIO | 3 STUDIO | 4S STUDIO | 4B 1-BR-C | 5B 1-BR-C | 5S STUDIO | 6 STUDIO | 7 STUDIO | 8 1-BR(A) | 9 1-BR(A) | 10 STUDIO | 11 STUDIO | 12 STUDIO | 13 STUDIO | 14 1-BR(B) | 15 1-BR(B) | 16 STUDIO | 17 STUDIO | 18 STUDIO | 19 STUDIO | 20 1-BR(A) |
| 6th Flr. | 1 1-BR | 2 STUDIO | 3 STUDIO | 4S STUDIO | 4B 1-BR-C | 5B 1-BR-C | 5S STUDIO | 6 STUDIO | 7 STUDIO | 8 1-BR(A) | 9 1-BR(A) | 10 STUDIO | 11 STUDIO | 12 STUDIO | 13 STUDIO | 14 1-BR(B) | 15 1-BR(B) | 16 STUDIO | 17 STUDIO | 18 STUDIO | 19 STUDIO | 20 1-BR(A) |
| 7th Flr. | 1 1-BR | 2 STUDIO | 3 STUDIO | 4S STUDIO | 4B 1-BR-C | 5B 1-BR-C | 5S STUDIO | 6 STUDIO | 7 STUDIO | 8 1-BR(A) | 9 1-BR(A) | 10 STUDIO | 11 STUDIO | 12 STUDIO | 13 STUDIO | 14 1-BR(B) | 15 1-BR(B) | 16 STUDIO | 17 STUDIO | 18 STUDIO | 19 STUDIO | 20 1-BR(A) |
| 8th Flr. | 1 1-BR | 2 STUDIO | 3 STUDIO | 4S STUDIO | 4B 1-BR-C | 5B 1-BR-C | 5S STUDIO | 6 STUDIO | 7 STUDIO | 8 1-BR(A) | 9 1-BR(A) | 10 STUDIO | 11 STUDIO | 12 STUDIO | 13 STUDIO | 14 1-BR(B) | 15 1-BR(B) | 16 STUDIO | 17 STUDIO | 18 STUDIO | 19 STUDIO | 20 1-BR(A) |

SOLD 169
SOCIAL HALL

SUMMARY:

| | | | |
|-------------------------|-----|-------------------------|----|
| TOTAL RESIDENTIAL UNITS | 170 | TOTAL PARKING SLOTS | 31 |
| TOTAL SOLD UNITS | 169 | TOTAL PARKING SOLD | 23 |
| TOTAL AVAILABLE UNITS | 1 | TOTAL PARKING AVAILABLE | 8 |

| BASEMENT PARKING | | | | | | | | | | | | | | | | | | | |
|------------------|----|----|----|----|----|----|----|----|----|----|----|----|----|----|----|----|--|--|--|
| | | 1 | 2 | 3 | 4 | 5 | 6 | 7 | 8 | 9 | 10 | 11 | 12 | 13 | 14 | | | | |
| 31 | 30 | 29 | 28 | 27 | 26 | 25 | 24 | 23 | 22 | 21 | 20 | 19 | 18 | 17 | 16 | 15 | | | |

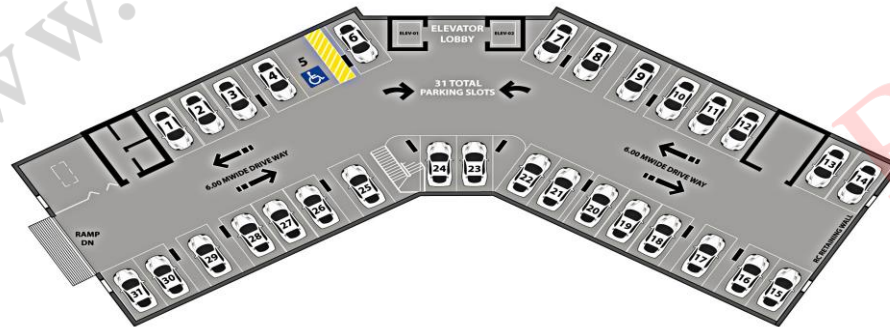

Note: This is the inventory of available spaces . All latest reservations beyond the said date may or may not be reflected on this chart. Kindly counter check at the developer's office (0917-723-9068 / (032) 262-5438) about space availability to level-off expectations from your client.



ANTARA 2 Inventory



TYPICAL FLOOR PLAN

| FLOOR | UNIT NUMBER | | | | | | | | | | | | | | | | | | | | | |
|-----------|------------------------|---------------|---------------|---------------|---------------|---------------|---------------|-------------------|---------------|----------------|----------------|----------------|----------------|----------------|----------------|----------------|----------------|----------------|----------------|----------------|----------------|-------------------------|
| | MOUNTAIN VIEW | | | | | | | SEA VIEW | | | | | | | MOUNTAIN VIEW | | | | | | | |
| 1st Flr. | 1 Studio A - Corner | 2 Studio A | 3 Studio B | 4 2 BR - A | 5 1 BR - C | 6 1 BR - D | 7 1 BR - D | RECEPTION & LOBBY | | 10 1 BR - D | 11 1 BR - D | 12 1 BR - C | 13 1 BR - A | 14 1 BR - A | 15 Studio A | 16 Studio A | 17 Studio A | 18 Studio A | 19 1 BR - B | 20 2 BR - B | 21 Studio A | 22 Studio A - Corner |
| 2nd Flr. | 1 Studio A - Corner | 2 Studio A | 3 Studio B | 4 2 BR - A | 5 1 BR - C | 6 1 BR - D | 7 1 BR - D | 8 Studio A | 9 Studio A | 10 1 BR - D | 11 1 BR - D | 12 1 BR - C | 13 1 BR - A | 14 1 BR - A | 15 Studio A | 16 Studio A | 17 Studio A | 18 Studio A | 19 1 BR - B | 20 2 BR - B | 21 Studio A | 22 Studio A - Corner |
| 3rd Flr. | 1 Studio A - Corner | 2 Studio A | 3 Studio B | 4 2 BR - A | 5 1 BR - C | 6 1 BR - D | 7 1 BR - D | 8 Studio A | 9 Studio A | 10 1 BR - D | 11 1 BR - D | 12 1 BR - C | 13 1 BR - A | 14 1 BR - A | 15 Studio A | 16 Studio A | 17 Studio A | 18 Studio A | 19 1 BR - B | 20 2 BR - B | 21 Studio A | 22 Studio A - Corner |
| 5th Flr. | 1 Studio A - Corner | 2 Studio A | 3 Studio B | 4 2 BR - A | 5 1 BR - C | 6 1 BR - D | 7 1 BR - D | 8 Studio A | 9 Studio A | 10 1 BR - D | 11 1 BR - D | 12 1 BR - C | 13 1 BR - A | 14 1 BR - A | 15 Studio A | 16 Studio A | 17 Studio A | 18 Studio A | 19 1 BR - B | 20 2 BR - B | 21 Studio A | 22 Studio A - Corner |
| 6th Flr. | 1 Studio A - Corner | 2 Studio A | 3 Studio B | 4 2 BR - A | 5 1 BR - C | 6 1 BR - D | 7 1 BR - D | 8 Studio A | 9 Studio A | 10 1 BR - D | 11 1 BR - D | 12 1 BR - C | 13 1 BR - A | 14 1 BR - A | 15 Studio A | 16 Studio A | 17 Studio A | 18 Studio A | 19 1 BR - B | 20 2 BR - B | 21 Studio A | 22 Studio A - Corner |
| 7th Flr. | 1 Studio A - Corner | 2 Studio A | 3 Studio B | 4 2 BR - A | 5 1 BR - C | 6 1 BR - D | 7 1 BR - D | 8 Studio A | 9 Studio A | 10 1 BR - D | 11 1 BR - D | 12 1 BR - C | 13 1 BR - A | 14 1 BR - A | 15 Studio A | 16 Studio A | 17 Studio A | 18 Studio A | 19 1 BR - B | 20 2 BR - B | 21 Studio A | 22 Studio A - Corner |
| 8th Flr. | 1 Studio A - Corner | 2 Studio A | 3 Studio B | 4 2 BR - A | 5 1 BR - C | 6 1 BR - D | 7 1 BR - D | 8 Studio A | 9 Studio A | 10 1 BR - D | 11 1 BR - D | 12 1 BR - C | 13 1 BR - A | 14 1 BR - A | 15 Studio A | 16 Studio A | 17 Studio A | 18 Studio A | 19 1 BR - B | 20 2 BR - B | 21 Studio A | 22 Studio A - Corner |
| 9th Flr. | 1 Studio A - Corner | 2 Studio A | 3 Studio B | 4 2 BR - A | 5 1 BR - C | 6 1 BR - D | 7 1 BR - D | 8 Studio A | 9 Studio A | 10 1 BR - D | 11 1 BR - D | 12 1 BR - C | 13 1 BR - A | 14 1 BR - A | 15 Studio A | 16 Studio A | 17 Studio A | 18 Studio A | 19 1 BR - B | 20 2 BR - B | 21 Studio A | 22 Studio A - Corner |
| 10th Flr. | 1 Studio A | 2 Studio A | 3 Studio B | 4 2 BR - A | 5 1 BR - C | 6 1 BR - D | 7 1 BR - D | 8 Studio A | 9 Studio A | 10 1 BR - D | 11 1 BR - D | 12 1 BR - C | 13 1 BR - A | 14 1 BR - A | 15 Studio A | 16 Studio A | 17 Studio A | 18 Studio A | 19 1 BR - B | 20 2 BR - B | 21 Studio A | 22 Studio A - Corner |
| 11th Flr. | 1 Studio A - Corner | 2 Studio A | 3 Studio B | 4 2 BR - A | 5 1 BR - C | 6 1 BR - D | 7 1 BR - D | 8 Studio A | 9 Studio A | 10 1 BR - D | 11 1 BR - D | 12 1 BR - C | 13 1 BR - A | 14 1 BR - A | 15 Studio A | 16 Studio A | 17 Studio A | 18 Studio A | 19 1 BR - B | 20 2 BR - B | 21 Studio A | 22 Studio A - Corner |

SOLD 205

SUMMARY:

| | | | |
|-------------------------|-----|-------------------------|----|
| TOTAL RESIDENTIAL UNITS | 218 | TOTAL PARKING SLOTS | 31 |
| TOTAL SOLD UNITS | 205 | TOTAL PARKING SOLD | 29 |
| TOTAL AVAILABLE UNITS | 13 | TOTAL PARKING AVAILABLE | 2 |

| BASEMENT PARKING | | | | | | | | | | | | | | | | | | |
|------------------|---|---|---|---|----|----|----|----|----|----|----|----|----|----|----|----|----|--|
| | | | | | 31 | 30 | 29 | 28 | 27 | 26 | 25 | 24 | 23 | 22 | 21 | 20 | 19 | |
| 1 | 2 | 3 | 4 | 5 | 6 | 7 | 8 | 9 | 10 | 11 | 12 | 13 | 14 | 15 | 16 | 17 | 18 | |

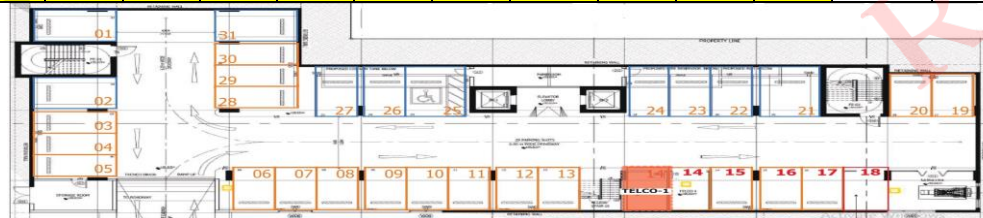

Note: This is the inventory of available spaces . All latest reservations beyond the said date may or may not be reflected on this chart. Kindly counter check at the developer's office (0917-723-9068 / (032) 262-5438) about space availability to level-off expectations from your client.

ANTARA 3 Inventory - RESIDENTIAL UNITS

| FLOOR | UNIT NUMBER | | | | | | | | | | | | | | | | | |
|-----------|---------------------------|---------------------------|---------------------------|---------------------------|---------------------------|---------------------------|---------------------------|---------------------------|---------------------------|----------------------------|----------------------------|----------------------------|----------------------------|----------------------------|----------------------------|-----------------------------|-----------------------------|----------------------------|
| | MOUNTAIN VIEW | | | | CITY - SEA VIEW | | | | CITY - SEA CORNER VIEW | | | | CITY - SEA VIEW | | | | | |
| 1st Flr. | 1 1 BR - A (41 sqm) | 2 STUDIO A (30 sqm) | 3 STUDIO A (30 sqm) | 4 1 BR - B (44 sqm) | 5 1 BR - B (44 sqm) | 6 STUDIO A (30 sqm) | 7 STUDIO A (30 sqm) | 8 1 BR - A (41 sqm) | 9 1 BR - C (35 sqm) | 10 STUDIO B (25 sqm) | 11 1 BR - D (48 sqm) | 12 1 BR - E (38 sqm) | RECEPTION & LOBBY | | 15 1 BR - E (38 sqm) | 16 1 BR - D (48 sqm) | 17 STUDIO B (25 sqm) | 18 1 BR - C (35 sqm) |
| 2nd Flr. | 1 1 BR - C (35 sqm) | 2 STUDIO B (25 sqm) | 3 STUDIO B (25 sqm) | 4 1 BR - F (36 sqm) | 5 1 BR - F (36 sqm) | 6 STUDIO B (25 sqm) | 7 STUDIO B (25 sqm) | 8 1 BR - C (35 sqm) | 9 1 BR - C (35 sqm) | 10 STUDIO B (25 sqm) | 11 1 BR - D (48 sqm) | 12 1 BR - E (38 sqm) | 13 STUDIO B (25 sqm) | 14 STUDIO B (25 sqm) | 15 1 BR - E (38 sqm) | 16 1 BR - D (48 sqm) | 17 STUDIO B (25 sqm) | 18 1 BR - C (35 sqm) |
| 3rd Flr. | 1 1 BR - C (35 sqm) | 2 STUDIO B (25 sqm) | 3 STUDIO B (25 sqm) | 4 1 BR - F (36 sqm) | 5 1 BR - F (36 sqm) | 6 STUDIO B (25 sqm) | 7 STUDIO B (25 sqm) | 8 1 BR - C (35 sqm) | 9 1 BR - C (35 sqm) | 10 STUDIO B (25 sqm) | 11 1 BR - D (48 sqm) | 12 1 BR - E (38 sqm) | 13 STUDIO B (25 sqm) | 14 STUDIO B (25 sqm) | 15 1 BR - E (38 sqm) | 16 1 BR - D (48 sqm) | 17 STUDIO B (25 sqm) | 18 1 BR - C (35 sqm) |
| 4th Flr. | 1 1 BR - C (35 sqm) | 2 STUDIO B (25 sqm) | 3 STUDIO B (25 sqm) | 4 1 BR - F (36 sqm) | 5 1 BR - F (36 sqm) | 6 STUDIO B (25 sqm) | 7 STUDIO B (25 sqm) | 8 1 BR - C (35 sqm) | 9 1 BR - C (35 sqm) | 10 STUDIO B (25 sqm) | 11 1 BR - D (48 sqm) | 12 1 BR - E (38 sqm) | 13 STUDIO B (25 sqm) | 14 STUDIO B (25 sqm) | 15 1 BR - E (38 sqm) | 16 1 BR - D (48 sqm) | 17 STUDIO B (25 sqm) | 18 1 BR - C (35 sqm) |
| 5th Flr. | 1 1 BR - C (35 sqm) | 2 STUDIO B (25 sqm) | 3 STUDIO B (25 sqm) | 4 1 BR - F (36 sqm) | 5 1 BR - F (36 sqm) | 6 STUDIO B (25 sqm) | 7 STUDIO B (25 sqm) | 8 1 BR - C (35 sqm) | 9 1 BR - C (35 sqm) | 10 STUDIO B (25 sqm) | 11 1 BR - D (48 sqm) | 12 1 BR - E (38 sqm) | 13 STUDIO B (25 sqm) | 14 STUDIO B (25 sqm) | 15 1 BR - E (38 sqm) | 16 1 BR - D (48 sqm) | 17 STUDIO B (25 sqm) | 18 1 BR - C (35 sqm) |
| 6th Flr. | 1 1 BR - C (35 sqm) | 2 STUDIO B (25 sqm) | 3 STUDIO B (25 sqm) | 4 1 BR - F (36 sqm) | 5 1 BR - F (36 sqm) | 6 STUDIO B (25 sqm) | 7 STUDIO B (25 sqm) | 8 1 BR - C (35 sqm) | 9 1 BR - C (35 sqm) | 10 STUDIO B (25 sqm) | 11 1 BR - D (48 sqm) | 12 1 BR - E (38 sqm) | 13 STUDIO B (25 sqm) | 14 STUDIO B (25 sqm) | 15 1 BR - E (38 sqm) | 16 1 BR - D (48 sqm) | 17 STUDIO B (25 sqm) | 18 1 BR - C (35 sqm) |
| 7th Flr. | 1 1 BR - C (35 sqm) | 2 STUDIO B (25 sqm) | 3 STUDIO B (25 sqm) | 4 1 BR - F (36 sqm) | 5 1 BR - F (36 sqm) | 6 STUDIO B (25 sqm) | 7 STUDIO B (25 sqm) | 8 1 BR - C (35 sqm) | 9 1 BR - C (35 sqm) | 10 STUDIO B (25 sqm) | 11 1 BR - D (48 sqm) | 12 1 BR - E (38 sqm) | 13 STUDIO B (25 sqm) | 14 STUDIO B (25 sqm) | 15 1 BR - E (38 sqm) | 16 1 BR - D (48 sqm) | 17 STUDIO B (25 sqm) | 18 1 BR - C (35 sqm) |
| 8th Flr. | 1 1 BR - C (35 sqm) | 2 STUDIO B (25 sqm) | 3 STUDIO B (25 sqm) | 4 1 BR - F (36 sqm) | 5 1 BR - F (36 sqm) | 6 STUDIO B (25 sqm) | 7 STUDIO B (25 sqm) | 8 1 BR - C (35 sqm) | 9 1 BR - C (35 sqm) | 10 STUDIO B (25 sqm) | 11 1 BR - D (48 sqm) | 12 1 BR - E (38 sqm) | 13 STUDIO B (25 sqm) | 14 STUDIO B (25 sqm) | 15 1 BR - E (38 sqm) | 16 1 BR - D (48 sqm) | 17 STUDIO B (25 sqm) | 18 1 BR - C (35 sqm) |
| 9th Flr. | 1 1 BR - C (35 sqm) | 2 STUDIO B (25 sqm) | 3 STUDIO B (25 sqm) | 4 1 BR - F (36 sqm) | 5 1 BR - F (36 sqm) | 6 STUDIO B (25 sqm) | 7 STUDIO B (25 sqm) | 8 1 BR - C (35 sqm) | 9 1 BR - C (35 sqm) | 10 STUDIO B (25 sqm) | 11 1 BR - D (48 sqm) | 12 1 BR - E (38 sqm) | 13 STUDIO B (25 sqm) | 14 STUDIO B (25 sqm) | 15 1 BR - E (38 sqm) | 16 1 BR - D (48 sqm) | 17 STUDIO B (25 sqm) | 18 1 BR - C (35 sqm) |
| 10th Flr. | 1 1 BR - C (35 sqm) | 2 STUDIO B (25 sqm) | 3 STUDIO B (25 sqm) | 4 1 BR - F (36 sqm) | 5 1 BR - F (36 sqm) | 6 STUDIO B (25 sqm) | 7 STUDIO B (25 sqm) | 8 1 BR - C (35 sqm) | 9 1 BR - C (35 sqm) | 10 2 BR - A (80 sqm) | 11 1 BR - D (48 sqm) | 12 1 BR - E (38 sqm) | 13 STUDIO B (25 sqm) | 14 STUDIO B (25 sqm) | 15 1 BR - E (38 sqm) | 16 1 BR - G1 (37 sqm) | 17 1 BR - G2 (37 sqm) | 18 1 BR - C (35 sqm) |
| 11th Flr. | 1 1 BR - C (35 sqm) | 2 STUDIO B (25 sqm) | 3 STUDIO B (25 sqm) | 4 1 BR - F (36 sqm) | 5 1 BR - F (36 sqm) | 6 STUDIO B (25 sqm) | 7 STUDIO B (25 sqm) | 8 1 BR - C (35 sqm) | 9 1 BR - C (35 sqm) | 10 2 BR - A (80 sqm) | 11 1 BR - D (48 sqm) | 12 1 BR - E (38 sqm) | 13 STUDIO B (25 sqm) | 14 STUDIO B (25 sqm) | 15 1 BR - E (38 sqm) | 16 1 BR - G1 (37 sqm) | 17 1 BR - G2 (37 sqm) | 18 1 BR - C (35 sqm) |
| 12th Flr. | 1 1 BR - C (35 sqm) | 2 STUDIO B (25 sqm) | 3 STUDIO B (25 sqm) | 4 1 BR - F (36 sqm) | 5 1 BR - F (36 sqm) | 6 STUDIO B (25 sqm) | 7 STUDIO B (25 sqm) | 8 1 BR - C (35 sqm) | 9 1 BR - C (35 sqm) | 10 2 BR - A (80 sqm) | 11 1 BR - D (48 sqm) | 12 1 BR - E (38 sqm) | 13 STUDIO B (25 sqm) | 14 STUDIO B (25 sqm) | 15 1 BR - E (38 sqm) | 16 1 BR - G1 (37 sqm) | 17 1 BR - G2 (37 sqm) | 18 1 BR - C (35 sqm) |
| 14th Flr. | 1 1 BR - C (35 sqm) | 2 STUDIO B (25 sqm) | 3 STUDIO B (25 sqm) | 4 1 BR - F (36 sqm) | 5 1 BR - F (36 sqm) | 6 STUDIO B (25 sqm) | 7 STUDIO B (25 sqm) | 8 1 BR - C (35 sqm) | 9 1 BR - C (35 sqm) | 10 2 BR - A (80 sqm) | 11 1 BR - D (48 sqm) | 12 1 BR - E (38 sqm) | 13 STUDIO B (25 sqm) | 14 STUDIO B (25 sqm) | 15 1 BR - E (38 sqm) | 16 1 BR - G1 (37 sqm) | 17 1 BR - G2 (37 sqm) | 18 1 BR - C (35 sqm) |
| 15th Flr. | 1 1 BR - C (35 sqm) | 2 STUDIO B (25 sqm) | 3 STUDIO B (25 sqm) | 4 1 BR - F (36 sqm) | 5 1 BR - F (36 sqm) | 6 STUDIO B (25 sqm) | 7 STUDIO B (25 sqm) | 8 1 BR - C (35 sqm) | 9 1 BR - C (35 sqm) | 10 2 BR - A (80 sqm) | 11 1 BR - D (48 sqm) | 12 1 BR - E (38 sqm) | 13 STUDIO B (25 sqm) | 14 STUDIO B (25 sqm) | 15 1 BR - E (38 sqm) | 16 1 BR - G1 (37 sqm) | 17 1 BR - G2 (37 sqm) | 18 1 BR - C (35 sqm) |

SUMMARY:

| | |
|-------------------------|-----|
| TOTAL RESIDENTIAL UNITS | 245 |
| TOTAL SOLD UNITS | 129 |
| TOTAL AVAILABLE UNITS | 116 |



UPPER GROUND FLOOR PLAN



TYPICAL 2ND TO 9TH FLOOR PLAN



TYPICAL 10TH TO 15TH FLOOR PLAN



ANTARA 3 Inventory - PARKING UNITS

BASEMENT PARKING

| | | | | | | | | | | | | | | | | | | |
|-------------------|-------------------|-------------------|-------------------|-------------------|-------------------|-------------------|-------------------|------------------|-------------------|-------------------|------------------------|-------------------|-------------------|-------------------|-------------------|-------------------|-------------------|-------------------|
| BP 1 (13 sqm) | BP 2 (13 sqm) | FIRE EXIT 1 | BP 3 (13 sqm) | BP 4 (13 sqm) | BP 5 (14 sqm) | BP 6 (14 sqm) | BP 7 (13 sqm) | ELEVATOR & LOBBY | BP 8 (13 sqm) | BP 9 (13 sqm) | RAMP UP TO LGF PARKING | FIRE EXIT 2 | BP 10 (13 sqm) | BP 11 (13 sqm) | | | | |
| BP 29 (13 sqm) | BP 28 (13 sqm) | BP 27 (20 sqm) | BP 26 (14 sqm) | BP 25 (14 sqm) | BP 24 (14 sqm) | BP 23 (16 sqm) | BP 22 (16 sqm) | ACCESS STAIRS | BP 21 (13 sqm) | BP 20 (14 sqm) | BP 19 (16 sqm) | BP 18 (16 sqm) | BP 17 (14 sqm) | BP 16 (14 sqm) | BP 15 (14 sqm) | BP 14 (20 sqm) | BP 13 (13 sqm) | BP 12 (13 sqm) |

LOWER GROUND PARKING

| | | | | | | | | | | | | | | | | |
|--------------------|--------------------|--------------------|-------------------------------|--------------------|--------------------|--------------------|--------------------|-------------------|--------------------|--------------------|--------------------|--------------------|--------------------------------|--------------------|--------------------|--------------------|
| LGP 1 (13 sqm) | LGP 2 (13 sqm) | FIRE EXIT 1 | RAMP DOWN TO BASEMENT PARKING | LGP 3 (14 sqm) | LGP 4 (13 sqm) | ELEVATOR & LOBBY | LGP 5 (13 sqm) | LGP 6 (14 sqm) | LGP 7 (14 sqm) | LGP 8 (13 sqm) | LGP 9 (13 sqm) | FIRE EXIT 2 | LGP 10 (13 sqm) | LGP 11 (13 sqm) | | |
| LGP 26 (13 sqm) | LGP 25 (13 sqm) | LGP 24 (20 sqm) | LGP 23 (14 sqm) | LGP 22 (14 sqm) | LGP 21 (14 sqm) | LGP 20 (16 sqm) | LGP 19 (16 sqm) | ACCESS STAIRS | LGP 18 (13 sqm) | LGP 17 (13 sqm) | LGP 16 (16 sqm) | LGP 15 (16 sqm) | RAMP UP TO ROAD (ENTRY / EXIT) | LGP 14 (20 sqm) | LGP 13 (13 sqm) | LGP 12 (13 sqm) |

SUMMARY:

TOTAL BASEMENT PARKING UNITS 29
 TOTAL SOLD UNITS 24
 TOTAL AVAILABLE UNITS 5

TOTAL LOWER GROUND PARKING UNITS 26
 TOTAL SOLD UNITS 9
 TOTAL AVAILABLE UNITS 17

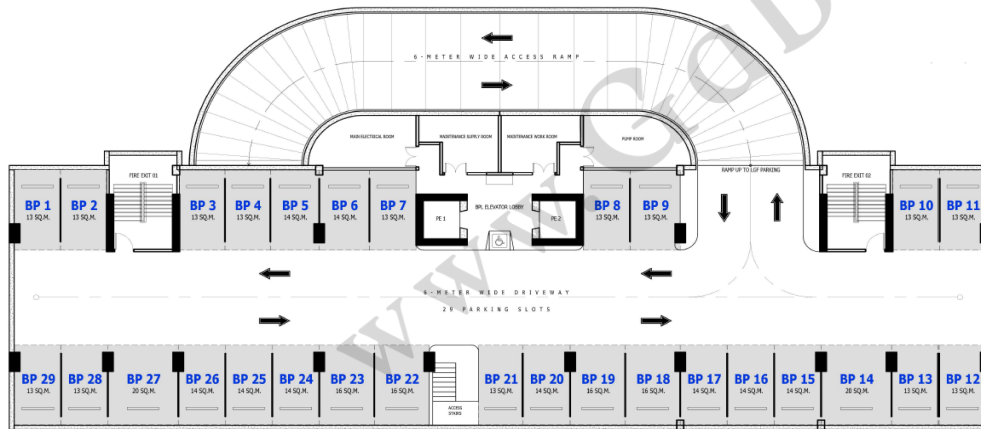

BASEMENT PARKING FLOOR PLAN

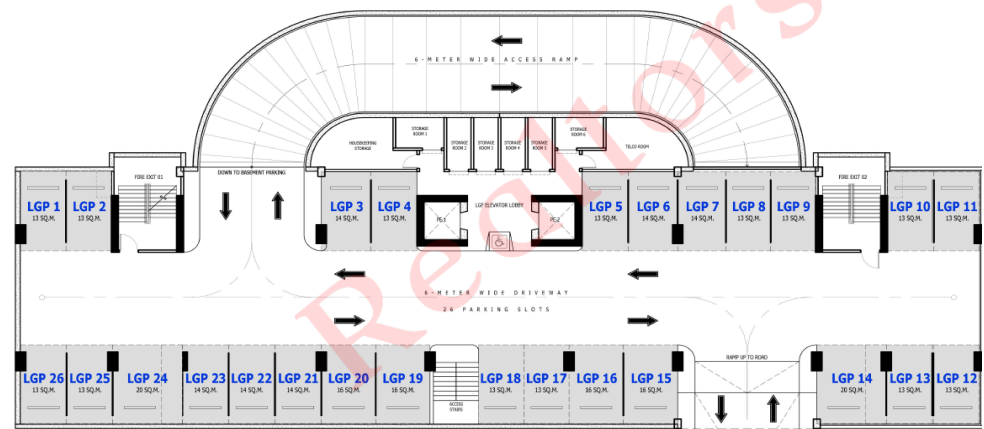

LOWER GROUND PARKING FLOOR PLAN

Note: This is the inventory of available spaces . All latest reservations beyond the said date may or may not be reflected on this chart. Kindly counter check at the developer's office (0917-723-9068 / (032) 262-5438) about space availability to level-off expectations from your client.